

Recording requested by and mail to:

Executive Officer
Local Agency Formation Commission
1042 Pacific Street
San Luis Obispo, CA 93401

PLACE RECORDING LABEL HERE

CERTIFICATE OF COMPLETION

Pursuant to Government Codes Section 57200 and 57201 this Certificate of Completion is hereby issued by the Executive Officer of the Local Agency Formation Commission of San Luis Obispo County, California.

1. The short-form designation by San Luis Obispo LAFCO is the Shandon-San Juan Water District
2. The name of the entity involved in the formation ordered by the Local Agency Formation Commission is as follows:

Shandon-San Juan Water District

3. The above-listed entity is located within San Luis Obispo County.
4. A description of the boundaries of the above-cited formation is shown in the attached Resolution, map and legal description, marked Exhibit A and by reference incorporated herein.
5. The territory involved in this landowner-voter District is subject to protest hearings which have been completed pursuant to Government Code Section 57000.
6. This action has been approved subject to the conditions of approval found in Exhibit B Resolution No. 2016-08.
7. The formation of this District is ordered by the Local Agency Formation Commission after the Protest Hearing has been conducted and the vote of the landowners within the boundaries, pursuant to Water Code 34000 et sec., has been completed

I hereby certify that I have examined the above-cited resolution for this action and have found this document to be in compliance with Resolution No. 2016-08 approving said action and adopted by the Local Agency Formation Commission of the County of San Luis Obispo on October 20, 2016.

Date: 5-22-17

LAFCO File No: 3-R-16



David Church
Executive Officer

Exhibit A

Map and Legal Description

SHANDON-SAN JUAN WATER DISTRICT

DISTRICT AREA	
SECTION	ACRES (APPROX)
1	1,234.5
2	1,345.6
3	1,456.7
4	1,567.8
5	1,678.9
6	1,789.0
7	1,890.1
8	1,901.2
9	2,012.3
10	2,123.4
11	2,234.5
12	2,345.6
13	2,456.7
14	2,567.8
15	2,678.9
16	2,789.0
17	2,890.1
18	2,901.2
19	3,012.3
20	3,123.4
21	3,234.5
22	3,345.6
23	3,456.7
24	3,567.8
25	3,678.9
26	3,789.0
27	3,890.1
28	3,901.2
29	4,012.3
30	4,123.4
31	4,234.5
32	4,345.6
33	4,456.7
34	4,567.8
35	4,678.9
36	4,789.0
37	4,890.1
38	4,901.2
39	5,012.3
40	5,123.4
41	5,234.5
42	5,345.6
43	5,456.7
44	5,567.8
45	5,678.9
46	5,789.0
47	5,890.1
48	5,901.2
49	6,012.3
50	6,123.4
51	6,234.5
52	6,345.6
53	6,456.7
54	6,567.8
55	6,678.9
56	6,789.0
57	6,890.1
58	6,901.2
59	7,012.3
60	7,123.4
61	7,234.5
62	7,345.6
63	7,456.7
64	7,567.8
65	7,678.9
66	7,789.0
67	7,890.1
68	7,901.2
69	8,012.3
70	8,123.4
71	8,234.5
72	8,345.6
73	8,456.7
74	8,567.8
75	8,678.9
76	8,789.0
77	8,890.1
78	8,901.2
79	9,012.3
80	9,123.4
81	9,234.5
82	9,345.6
83	9,456.7
84	9,567.8
85	9,678.9
86	9,789.0
87	9,890.1
88	9,901.2
89	10,012.3
90	10,123.4
91	10,234.5
92	10,345.6
93	10,456.7
94	10,567.8
95	10,678.9
96	10,789.0
97	10,890.1
98	10,901.2
99	11,012.3
100	11,123.4

LEGEND

- SHANDON-SAN JUAN WATER DISTRICT BOUNDARY
- SECTION
- TRACTS AND TOWNSHIPS
- MAJOR ROADS
- MINOR ROADS
- SHANDON, CA

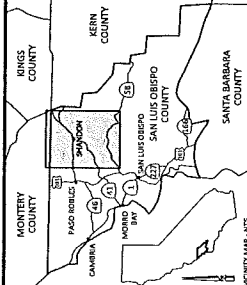
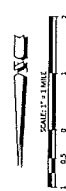

McYellor
A PROFESSIONAL LAND SURVEYING & CONSULTING COMPANY
2005 South Main Street, Suite 107
San Luis Obispo, CA 93401
805-488-1888 fax
805-488-1889
http://www.mcyellor.com

PREPARED BY:

APPROVED BY L.A.F.C.

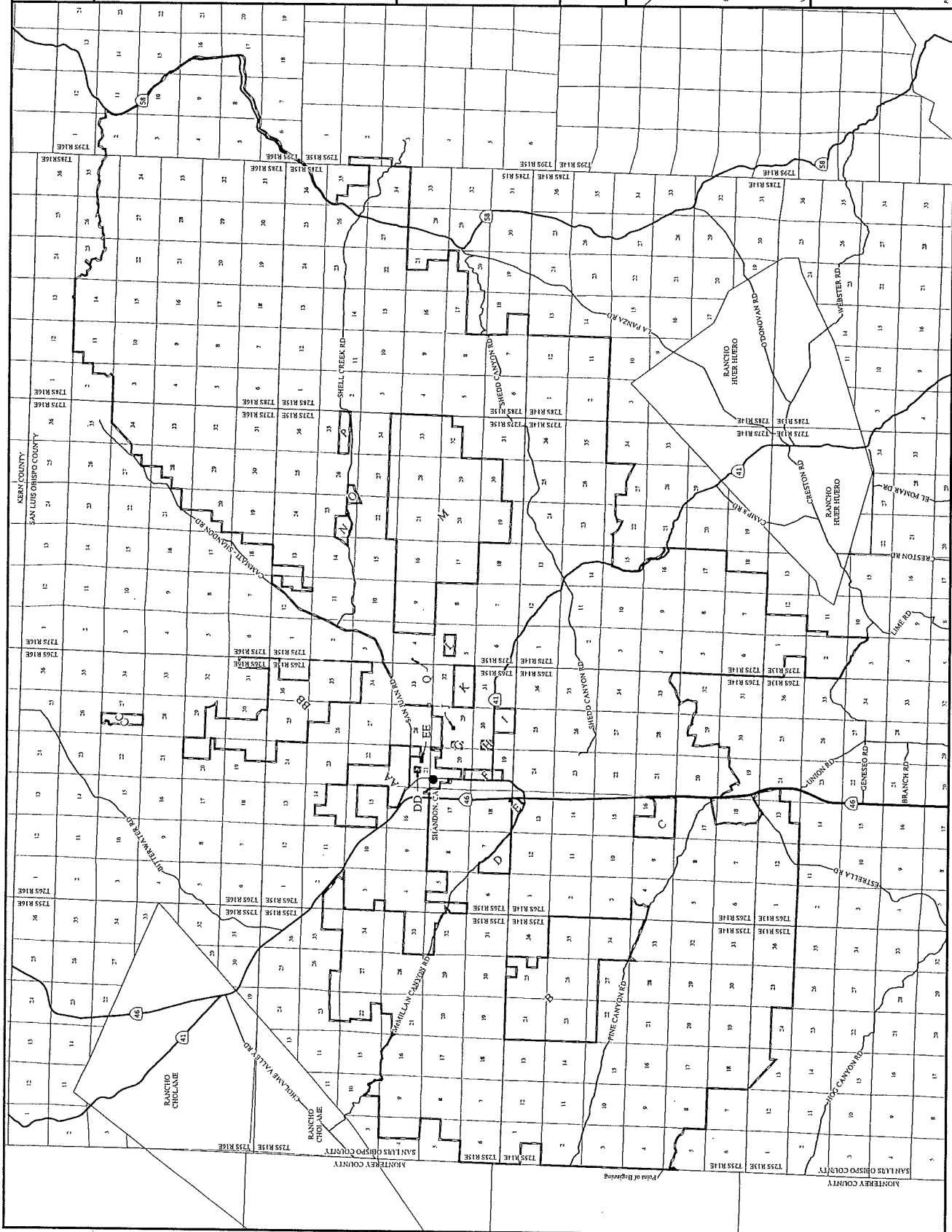

Shandon-San Juan Water District

Special District Description

The following described lines and curves were derived from a composite of information, adjusted to overlay the GIS shapefile of the Public Land Survey System, available for download from the Natural Resource Conservation Service, United States Department of Agriculture (<https://gdg.sc.egov.usda.gov/GDGHome.aspx>), in an effort to create a closed polygon for LAFCO mapping and area calculation purposes. Lines and curves described within may vary from the values described in the various legal references. Controlling calls within the body of this description are paramount to the quantitative calls made within and hereby control the exterior boundary location of this Special District.

Being all those portions of Township 25 South, Range 13 East, Township 25 South, Range 14 East, Township 25 South, Range 15 East, Township 26 South, Range 13 East, Township 26 South, Range 14 East, Township 26 South, Range 15 East, Township 26 South, Range 16 East, Township 27 South, Range 13 East, Township 27 South, Range 14 East, Township 27 South, Range 15 East, Township 27 South, Range 16 East, Township 28 South, Range 14 East, Township 28 South, Range 15 East, Township 28 South, Range 16 East, Township 29 South, Range 15 East, and Township 29 South, Range 16 East, Mount Diablo Meridian, in the County of San Luis Obispo County, State of California, described as follows:

Beginning at the Northwest corner of Section 4, T25S, R14E, MDM; thence, along the Northerly line of said Section 4,

- 1) S 88°26'22" E, a distance of 5288.20 feet to the Northerly corner common to Section 4 and 3, thence,
- 2) S 88°27'16" E, along the North line of said Section 3, a distance of 5292.21 feet to the Northerly corner common to Section 3 and 2; thence,
- 3) S 88°30'21" E, along the North line of said Section 2, a distance of 5280.90 feet to the Northerly corner common to Section 2 and 1; thence,
- 4) S 01°40'44" W, along the line common to said Section 2 and 1, a distance of 2723.29 feet to the West one-quarter corner of said Section 1; thence,
- 5) S 88°55'25" E, along the South line of the Northwest one-quarter of said Section 1, a distance of 2647.07 feet to the Center of said Section 1; thence,
- 6) N 01°40'41" E, along the East line of said Northwest one-quarter, 2706.10 feet to the North one-quarter corner of said Section 1; thence,
- 7) S 88°32'39" E, along the North line of said Section 1, a distance of 2646.83 feet to the Northerly corner common to Section 1 and Section 6, T25S, R15E, MDM; thence,
- 8) S 88°17'33" E, along the North line of said Section 6 a distance of 5265.54 feet to the Northerly corner common to Section 6 and Section 5; thence,
- 9) S 02°57'19" W, along the West line of the Northwest one-quarter of said Section 5, a distance of 2731.33 feet to the West one-quarter corner of said Section 5; thence,
- 10) S 88°18'24" E, along the South line of said Northwest one-quarter, a distance of 2650.42 feet to the Center of said Section 5; thence,
- 11) S 02°0'13" W, along the West line of the Southeast one-quarter of said Section 5, a distance of 2622.16 feet to the South one-quarter corner of said Section 5; thence,

- 12) S 87°19'24" E, along the South line of said Southeast one-quarter, a distance of 2594.03 feet to the South corner common to said Section 5 and Section 4; thence,
- 13) N 04°11'15" E, along the West line of the Southwest one-quarter of said Section 4, a distance of 2669.17 feet to the one-quarter corner common to said Section 5 and 4; thence,
- 14) S 89°02'30" E, along the South line of the North one-half of said Section 4, a distance of 5267.33 feet to the East one-quarter corner of said Section 4; thence,
- 15) S 00°24'34" W, along the East line of said Section 4, a distance of 2707.21 feet to the corner common to Sections 4, 3, 10 and 9; thence,
- 16) S 00°46'56" W, along the West line of said Section 10, a distance of 2636.89 feet to the West one-quarter corner of said Section 10; thence,
- 17) S 88°5'14" E, along the South line of the Northwest one-quarter of said Section 10, a distance of 2007.44 feet to the Northeasterly corner of the land described in the Quitclaim Deed recorded November 12, 2010 as Instrument No. 2010057253, said corner also being a point in the Westerly line of County Road No. 5228 (McMillan Canyon Road); thence, along said Westerly line per said deed through Sections 10, 9, and 16, the following 124 courses and distances,
 - 18) S 24°24'19" W, 15.42 feet;
 - 19) S 35°42'05" W, 101.26 feet;
 - 20) S 40°31'06" W, 29.13 feet;
 - 21) S 51°44'29" W, 30.16 feet;
 - 22) S 63°59'16" W, 29.65 feet;
 - 23) S 76°57'31" W, 40.62 feet;
 - 24) S 66°23'21" W, 82.34 feet;
 - 25) S 55°14'37" W, 53.72 feet ;
 - 26) S 48°57'44" W, 49.17 feet ;
 - 27) S 42°45'30" W, 49.41 feet ;
 - 28) S 35°42'02" W, 66.18 feet ;
 - 29) S 40°04'33" W, 87.54 feet ;
 - 30) S 44°52'17" W, 167.24 feet ;
 - 31) S 37°03'37" W, 48.19 feet ;
 - 32) S 30°50'55" W, 47.26 feet ;
 - 33) S 25°07'52" W, 54.25 feet ;
 - 34) S 20°40'42" W, 169.19 feet ;
 - 35) S 24°12'04" W, 204.10 feet;
 - 36) S 23°15'25" W, 31.75 feet;
 - 37) S 07°09'25" W, 26.10 feet;
 - 38) S 07°58'52" W, 11.32 feet;
 - 39) S 01°04'49" W, 16.47 feet;
 - 40) S 00°15'34" W, 29.88 feet;
 - 41) S 10°33'46" E, 25.14 feet;
 - 42) S 20°05'59" E, 47.72 feet;
 - 43) S 37°20'44" E, 85.75 feet;
 - 44) S 54°13'00" E, 74.22 feet;
 - 45) S 60°27'39" E, 84.72 feet;
 - 46) S 49°41'06" E, 51.93 feet;
 - 47) S 56°15'37" E, 18.89 feet;
 - 48) S 41°14'11" E, 21.14 feet;
 - 49) S 21°51'06" E, 24.42 feet;

- 50) S 04°28'40" E, 25.36 feet;
- 51) S 32°39'21" W, 19.70 feet;
- 52) S 54°21'48" W, 10.19 feet;
- 53) S 67°35'50" W, 12.47 feet;
- 54) S 81°14'57" W, 118.08 feet;
- 55) S 69°38'27" W, 62.88 feet;
- 56) S 59°32'17" W, 64.37 feet;
- 57) S 72°50'19" W, 39.87 feet;
- 58) S 87°18'24" W, 51.17 feet;
- 59) S 76°10'25" W, 57.02 feet;
- 60) S 63°39'11" W, 56.98 feet;
- 61) S 55°00'52" W, 306.87 feet;
- 62) S 58°57'00" W, 133.77 feet;
- 63) S 55°37'56" W, 37.94 feet;
- 64) S 48°50'53" W, 32.94 feet;
- 65) S 39°51'51" W, 62.99 feet;
- 66) S 31°53'46" W, 87.26 feet;
- 67) S 57°49'51" W, 13.55 feet;
- 68) S 81°55'38" W, 13.62 feet;
- 69) N 73°24'28" W, 13.84 feet;
- 70) N 51°10'37" W, 45.83 feet;
- 71) N 62°01'59" W, 35.14 feet;
- 72) N 75°32'20" W, 88.69 feet;
- 73) N 83°05'48" W, 58.80 feet;
- 74) N 89°35'14" W, 69.67 feet;
- 75) S 83°41'02" W, 45.70 feet;
- 76) S 79°01'01" W, 68.15 feet;
- 77) S 74°20'26" W, 100.31 feet;
- 78) S 67°50'24" W, 23.77 feet;
- 79) S 84°29'53" W, 20.88 feet;
- 80) N 74°38'10" W, 18.09 feet;
- 81) N 74°38'10" W, 13.97 feet;
- 82) N 81°23'53" W, 57.37 feet;
- 83) N 89°40'34" W, 44.38 feet;
- 84) S 79°02'17" W, 17.29 feet;
- 85) S 69°36'58" W, 41.11 feet;
- 86) S 57°40'39" W, 41.54 feet;
- 87) S 46°09'41" W, 41.59 feet;
- 88) S 34°07'27" W, 109.09 feet;
- 89) S 24°05'45" W, 45.39 feet;
- 90) S 07°12'32" W, 49.28 feet;
- 91) S 08°29'00" E, 34.38 feet;
- 92) S 20°17'10" E, 33.02 feet;
- 93) S 31°34'27" E, 228.54 feet;
- 94) S 37°36'18" E, 112.57 feet;
- 95) S 32°50'34" E, 89.29 feet;
- 96) S 19°44'44" E, 31.95 feet;
- 97) S 08°06'06" E, 31.94 feet;
- 98) S 04°22'08" W, 133.20 feet;

- 99) S 01°29'59" W, 541.11 feet;
- 100) S 00°32'45" E, 112.91 feet;
- 101) S 00°45'27" E, 69.00 feet;
- 102) S 01°09'25" E, 41.08 feet;
- 103) S 01°47'14" W, 637.39 feet;
- 104) S 07°52'18" W, 46.31 feet;
- 105) S 11°20'29" W, 116.00 feet;
- 106) S 18°54'28" W, 76.35 feet;
- 107) S 24°33'02" W, 205.43 feet;
- 108) S 19°43'51" W, 70.70 feet;
- 109) S 12°56'21" W, 55.40 feet;
- 110) S 06°50'22" W, 54.75 feet;
- 111) S 01°01'14" W, 54.76 feet;
- 112) S 04°28'31" E, 118.99 feet;
- 113) S 09°46'51" E, 74.47 feet;
- 114) S 08°07'46" E, 63.66 feet;
- 115) S 12°53'15" E, 51.83 feet;
- 116) S 14°35'17" E, 112.83 feet;
- 117) S 15°06'57" E, 225.13 feet;
- 118) S 08°13'50" E, 60.57 feet;
- 119) S 05°51'10" W, 52.75 feet;
- 120) S 13°46'00" W, 50.06 feet;
- 121) S 34°52'40" W, 141.61 feet;
- 122) S 45°24'40" W, 56.20 feet;
- 123) S 37°59'22" W, 95.55 feet;
- 124) S 33°31'00" W, 158.56 feet;
- 125) S 36°20'44" W, 64.65 feet;
- 126) S 42°29'35" W, 112.36 feet;
- 127) S 46°18'35" W, 129.68 feet;
- 128) S 45°22'48" W, 234.24 feet;
- 129) S 44°41'42" W, 146.64 feet;
- 130) S 39°55'53" W, 89.91 feet;
- 131) S 33°55'11" W, 66.17 feet;
- 132) S 27°10'35" W, 108.44 feet;
- 133) S 17°27'17" W, 211.54 feet;
- 134) S 22°17'13" W, 81.40 feet;
- 135) S 26°45'34" W, 144.46 feet;
- 136) S 30°33'18" W, 224.14 feet;
- 137) S 28°11'43" W, 89.31 feet;
- 138) S 30°52'06" W, 93.31 feet;
- 139) S 35°18'09" W, 122.30 feet;
- 140) S 24°15'32" W, 24.69 feet;
- 141) S 16°08'47" W, 57.40 feet;
- 142) S 65°57'43" W, leaving said westerly line, 400.49 feet to a point in the common line between Sections 16 and 21; thence,
- 143) S 87°45'58" E, 365.53 feet along said common line to the northerly terminus of the easterly line of Parcel 27 of Parcel Map COAL 81-266 filed in Parcel Map Book 32, Page 74; thence, along the Easterly line of said Parcel 27 the following 2 courses;
- 144) S 00°40'05" E, 2565.82 feet;

- 145) S 88°22'15" E, 1331.76 feet to a point in the Westerly line of Parcel 22 of said Parcel Map; thence,
- 146) S 00°59'15" E, along the West line of said Parcel 22, a distance of 1276.28 feet to the Southwest corner thereof, said corner also being the Northwest corner of Parcel 28 of said Parcel Map; thence, along the exterior boundary of said Parcel 28 the following 9 courses;
 - 147) S 87°31'016" E, 1344.52 feet;
 - 148) N 01°3'39" W, 2206.50 feet;
 - 149) S 86°51'49" E, 2685.51 feet;
 - 150) N 01°12'31" W, 330.95 feet;
 - 151) S 86°51'49" E, 1342.32 feet;
 - 152) S 88°51'6" E, 1325.05 feet;
 - 153) S 00°37'47" E, 3808.05 feet;
 - 154) S 01°29'21" W, 2623.79 feet;
 - 155) N 86°30'38" W, 1307.41 feet to the Northeast corner of Parcel 24 of said Parcel Map; thence,
 - 156) S 01°57'34" W, along the East line of said Parcel 24, a distance of 2642.36 feet to the Northeast corner of Parcel 23 of said Parcel Map; thence,
 - 157) S 02°41'58" W, along the East line of said Parcel 23, a distance of 2653.65 feet to a point in the Northerly line of the land described in the Re-recorded Grant Deed recorded October 27, 2011 as Instrument No. 2011053844 OR; thence, along the exterior boundary of the land described in said Re-recorded Grant Deed and along the exterior boundary of the land described in the Trustees Deed Upon Sale recorded April 22, 2011 as Instrument No. 2011019608 OR, the following 11 courses;
 - 158) S 88°01'08" E, 2651.33 feet;
 - 159) S 02°49'52" W, 2623.67 feet;
 - 160) S 00°11'27" E, 1751.97 feet;
 - 161) S 41°36'35" W, 2210.58 feet;
 - 162) S 22°09'40" E, 223.01 feet;
 - 163) S 40°33'15" W, 120.59 feet;
 - 164) S 40°33'15" W, 659.56 feet;
 - 165) N 57°32'04" W, 863.52 feet;
 - 166) S 00°09'47" W, 1210.50 feet;
 - 167) S 84°56'23" W, 43.99 feet;
 - 168) N 00°10'54" E, 4807.68 feet to a point in the Southerly boundary of the land described in said Trustees Deed of Sale recorded April 22, 2011 as Instrument No. 2011019608 OR; thence, along said Southerly boundary and along the Southerly boundary of the land described in said Re-recorded Grant Deed recorded October 27, 2011 as Instrument No. 2011053846 OR, the following 7 courses;
 - 169) N 88°40'00" W, 208.71 feet;
 - 170) N 00°10'09" E, 208.71 feet;
 - 171) N 88°39'52" W, 2416.49 feet;
 - 172) N 88°00'13" W, 1340.70 feet to the Northeast corner of Parcel 21 of said Parcel Map COAL 81-266; thence,
 - 173) S 00°47'54" W, along the East line of said Parcel 21, a distance of 1336.88 feet to the Southeast corner thereof; thence,
 - 174) N 88°38'56" W, along the South line of said Parcel 21, a distance of 1342.94 feet to the Southwest corner thereof; thence,

- 175) N 00°54'16" E, along the West line of said Parcel 21, a distance of 1352.05 feet to the most Southeast corner of Parcel 20 of said Parcel Map; thence,
- 176) N 88°29'50" W, along the South line of said Parcel 20, a distance of 2642.48 feet to the Southwest corner thereof; thence,
- 177) N 02°17'58" E, along the West line of said Parcel 20, a distance of 5370.27 feet to the Northwest corner thereof, said corner also being the Southeast corner of Parcel 17 of said Parcel Map; thence,
- 178) N 87°47'59" W, along the Southerly line of Parcels 17 and 16 of said Parcel Map, 2628.95 feet to the Southwest corner of said Parcel 16, said corner also being the Southeast corner of Parcel 15 of said Parcel Map; thence,
- 179) N 89°40'46" W, along a portion of the South line of said Parcel 15, a distance of 1364.99 feet to the Northwest corner of FR 32 as shown on said Parcel Map COAL 81-266, said corner also being an angle point in Parcel 14 of said Parcel Map; thence, along the East line of said Parcel 14 and along the East and South line of Parcel 13 of said Parcel Map the following 10 courses,
 - 180) S 02°13'37" W, 4036.98 feet
 - 181) N 89°04'39" W, 399.24 feet;
 - 182) S 23°52'34" W, 1021.05 feet;
 - 183) S 40°22'34" W, 522.67 feet;
 - 184) N 88°52'26" W, 205.05 feet;
 - 185) S 01°07'34" W, 406.82 feet;
 - 186) S 08°07'26" E, 325.36 feet;
 - 187) N 48°52'26" W, 593.57 feet;
 - 188) N 28°52'26" W, 400.00 feet;
 - 189) N 88°48'46" W, 2126.81 feet; to the Northeast corner of Section 6, T26S, R15E, MDM; thence,
- 190) S 01°19'51" W, along the East line of said Section 6, a distance of 1330.54 feet to the Southwest corner of the Northwest one-quarter of the Northwest one-quarter of Section 5, T26S, R15E, MDM; thence,
- 191) S 88°34'16" E, along the South line of the North one-half of the North one-half of said Section 5, a distance of 5378.09 feet to the Southeast corner of the Northeast one-quarter of the Northeast one-quarter of said Section 5; thence,
- 192) S 01°18'31" W, along the East line of said Section 5, a distance of 1319.54 feet to the East one-quarter corner of said Section 5; thence,
- 193) N 88°34'59" W, along the South line of the Northeast one-quarter of said Section 5, a distance of 2688.44 feet to the Center of said Section 5; thence,
- 194) S 01°18'05" W, along the West line of the Southeast one-quarter of said Section 5, a distance of 2640.30 feet to the South one-quarter corner of said Section 5; thence,
- 195) S 88°38'03" E, along the South line of said Southeast one-quarter, to the Northeast corner of Section 8, T26S, R15E, MDM; thence,
- 196) S 01°22'54" W, along the East line of said Section 8, a distance of 5285.00 feet to the Northeast corner of Section 17; thence,
- 197) S 01°39'33" W, along the East line of said Section 17, a distance of 4628.04 feet to the Northwest corner of Parcel 1 of Parcel Map COAL 90-301 recorded in Parcel Map Book 48, Page 100; thence, along the exterior of said Parcel 1 the following 5 courses,
 - 198) S 88°37'11" E, 669.70 feet;
 - 199) S 00°49'17" W, 150.00 feet;
 - 200) N 88°37'11" W, 190.00 feet;
 - 201) S 40°34'42" W, 464.80 feet;

- 202) N 88°37'11" W, 190.14 feet to a point in the East line of said Section 17, said point also being a point in the East line of the land described in the Grant Deed recorded December 11, 2001 as Instrument No. 2001095664 OR; thence, along the exterior boundary of said Grant Deed 2001095664 OR the following 12 courses,
- 203) S 01°41'14" W, 150.00 feet;
- 204) N 87°55'52" W, 1338.81 feet;
- 205) S 00°00'00" E, 333.00 feet;
- 206) N 90°00'00" W, 30.00 feet;
- 207) S 00°00'00" E, 471.24 feet;
- 208) N 88°10'44" W, 1039.64 feet;
- 209) S 01°49'16" W, 500.00 feet;
- 210) N 88°10'44" W, 35.00 feet;
- 211) N 01°49'16" E, 500.00 feet;
- 212) N 88°10'44" W, 260.00 feet;
- 213) S 01°49'16" W, 500.00 feet;
- 214) N 87°49'13" W, 1339.09 feet to the Northeast corner of the land described in the Grant Deed recorded June 21, 2013 as Instrument No. 2013036105 OR; thence,
- 215) S 01°49'39" W, along the East line of said Grant Deed, 1308.22 feet to the Southeast corner thereof, said corner also being the Southeast corner of the Southwest one-quarter of Northwest one-quarter of Section 20, T26S, R15E, MDM; thence,
- 216) S 87°42'48" E, along the East/West midline of said Section 20, a distance of 2672.72 feet to the Southeast corner of the Southwest one-quarter of the Northeast one-quarter of said Section 20, said corner also being the Northwest corner of the land described in the Quitclaim Deed recorded October 28, 2009 as Instrument No. 2009060350 OR; thence,
- 217) S 87°42'40" E, along the Northerly line of said Quitclaim Deed 2009060350 OR, 673.48 feet to the Northeast corner; thence,
- 218) S 01°43'58" W, along the Easterly line of said Quitclaim Deed 2009060350 OR and the Easterly line of the land described in the Grant Deed recorded May 16, 2013 as Instrument No. 2013028490 OR, 1316.54 feet to the Southeast corner of said Grant Deed 2013028490 OR; thence,
- 219) N 87°47'22" W, along the Southerly line of said Grant Deed 2013028490 OR, 672.61 feet to the Southwest corner thereof, said corner also being the Northeast corner of the land described in the Grant deed recorded November 8, 2001 as Instrument No. 2001087109; thence,
- 220) S 01°41'42" W, along the East line of said Grant Deed 2001087109 OR, 919.99 feet to the Northwest corner of the land described in the Grant Deed recorded July 2, 2004 as Instrument No. 2004058324 OR; thence,
- 221) S 84°56'38" E, along the Northerly line of said Grant Deed 2004058324 OR, 1346.33 feet to the Northeast corner thereof; thence,
- 222) S 01°46'32" W, along the East line of said Grant Deed 2004058324 OR, 329.09 feet to the Southeast corner thereof; thence,
- 223) N 83°59'50" W, along the South line of said Grant Deed 2004058324 OR, 1347.41 feet to the Northeast corner of the land described in the Grant Deed recorded June 24, 2013 as Instrument No. 2013036354 OR; thence,
- 224) N 88°58'40" W, along the North line of said Grant Deed 2013036354 OR, 131.94 feet to the Northwest corner thereof; thence,
- 225) S 01°18'49" W, along the West line of said Grant Deed 2013036354 OR, 330.15 feet to the Southwest corner thereof; thence,

- 226) S 89°02'27" E, along the South line of said Grant Deed 2013036354 OR, 132.00 feet to the Northeasterly corner of the land described in the Quitclaim Deed recorded December 19, 2012 as Instrument No. 2012074589 OR; thence along the Easterly line of said Quitclaim Deed 2012074589 OR the following 3 courses,
- 227) S 01°18'11" W, 3681.68 feet;
- 228) S 87°11'38" E, 1337.76 feet;
- 229) S 01°23'03" W, 1312.11 feet to the Northwest corner of Parcel 1 of Parcel Map COAL 03-0158 record in Book 61 of Parcel Maps, Page 83; thence;
- 230) S 87°46'26" E, along the North Line of said Parcel 1, a distance of 339.00 feet; thence,
- 231) S 02°13'34" W, continuing along said North line, 200.00 feet; thence,
- 232) S 87°46'26" E, continuing along said North line, 200.00 feet; thence,
- 233) N 02°13'34" E, continuing along said North line, 200.00 feet; thence,
- 234) S 87°46'26" E, continuing along said North line and along the North line of 1 of Parcel Map CO 05-0372 recorded in Book 73 of Parcel Maps, Page 26, a distance of 3414.60 feet to the Northeast corner thereof; thence,
- 235) S 20°52'31" E, along the East line of said Parcel 1, a distance of 1907.84 feet to the Northeast corner of Parcel 2 of said Parcel Map CO 05-0372; thence,
- 236) S 22°27'19" E, along the East line of said Parcel 2, a distance of 1443.87 feet to an angle point therein; thence,
- 237) S 60°40'49" W, continuing along said East line, 31.17 feet to an angle point therein; thence,
- 238) S 29°18'13" E, continuing along said East line, 807.49 feet to the Northeast corner of Parcel 3 of said Parcel Map CO 05-0372; thence,
- 239) S 29°17'56" E, along the East line of said Parcel 3, a distance of 1729.41 feet to the Northeast corner of Parcel 4 of said Parcel Map CO 05-0372; thence,
- 240) S 29°24'33" E, along the East line of said Parcel 4, a distance of 77.69 feet to an angle point therein; thence, continuing along said East line,
- 241) S 01°19'16" W, a distance of 369.64 feet to the beginning of a curve concave easterly having a radius of 1230.00 feet, a delta angle of 11° 18' 04", the radial center bears S 89° 06' 20" E; thence,
- 242) Southerly, along the arc of said curve a distance of 242.61 feet to the Northerly corner of Parcel 1 of Parcel Map CO 83-214 recorded in Book 46 of Parcel Maps, Page 30, said corner being the beginning of a curve concave northeasterly, having a radius of 1230.00 feet, a delta angle of 07° 49' 49", the radial center of which bears N 79° 35' 37" E; thence, along the Northeasterly lines of Parcels 1, 2, 3, and 4 of said Parcel Map CO 83-214, also being the Southwesterly Right-of-Way of the Shandon-San Juan and Cammatti-Shandon Road the following 22 courses
- 243) Southeasterly along the arc of said curve a distance of 168.10 feet; thence,
- 244) S 18°03'13" E, a distance of 624.96 feet to the beginning of a curve concave northeasterly having a radius of 1030.00 feet, a delta angle of 09° 22' 56", the radial center of which bears N 71° 54' 40" E; thence,
- 245) Southeasterly along the arc of said curve a distance of 168.66 feet; thence,
- 246) S 27°29'59" E, a distance of 1409.49 feet to the beginning of a curve concave northeasterly having a radius of 630.00 feet, a delta angle of 37° 25' 51", the radial center of which bears N 61°54' 01" E; thence,
- 247) Southeasterly along the arc of said curve a distance of 411.57 feet; thence,
- 248) S 65°10'47" E, a distance of 1904.69 feet to the beginning of a curve concave northeasterly, having a radius of 1930.00 feet, a delta angle of 25° 36' 45", the radial center of which bears N 24°45'18" E; thence,

- 249) Southeasterly along the arc of said curve a distance of 862.75 feet; thence,
250) N 88°41'17" E, a distance of 865.63 feet to the beginning of a curve concave southwesterly, having a radius of 770.00 feet, a delta angle of 27° 29' 43", the radial center of which bears S 01° 18' 43" E; thence,
251) Southeasterly along the arc of said curve a distance of 369.51 feet; thence,
252) S 63°48'59" E, a distance of 1117.38 feet to the Northwest corner of said Parcel 2, said corner being the beginning of a curve concave southwesterly, having a radius of 1470.00 feet, a delta angle of 00° 48' 36", the radial center of which bears S 26°11'01" W; thence,
253) Southeasterly along the arc of said curve a distance of 20.78 feet to the beginning of a curve concave southwesterly, having a radius of 1470.00 feet, a delta angle of 05° 09' 11", the radial center of which bears S 26°59'37" W; thence,
254) Southeasterly along the arc of said curve a distance of 132.21 feet; thence,
255) S 57°51'12" E, a distance of 732.98 feet to the beginning of a curve concave northeasterly, having a radius of 1930.00 feet, a delta angle of 09° 01' 40", the radial center of which bears N 32°08'48" E; thence,
256) Southeasterly along the arc of said curve a distance of 304.10 feet; thence,
257) S 66°52'53" E, a distance of 1032.54 feet to the Northwest corner of said Parcel 3; thence,
258) S 66°52'53" E, a distance of 2977.32 feet to the beginning of a curve concave southwesterly, having a radius of 970.00 feet, a delta angle of 24° 04' 18", the radial center of which bears S 23°07'07" E; thence,
259) Southeasterly along the arc of said curve a distance of 407.52 feet; thence,
260) S 42°48'35" E, a distance of 1497.41 feet to the Northwest corner of said Parcel 4; thence,
261) S 42°48'35" E, a distance of 851.47 feet to the beginning of a curve concave northeasterly, having a radius of 1630.00 feet, a delta angle of 11° 00' 10", the radial center of which bears N 48°22'19" E; thence,
262) Southeasterly along the arc of said curve a distance of 313.02 feet; thence,
263) S 53°37'51" E, a distance of 1867.98 feet to the Northeast corner of said Parcel 4; thence,
264) S 01°06'52" W, a distance of 985.66 feet to the South line of said Parcel 4,
265) N 87°46'00" W, a distance of 1319.19 feet to the Southwest corner thereof; thence,
266) N 01°26'53" E, along the West line of said Parcel 4, a distance of 1341.39 feet; thence,
267) N 87°44'49" W, continuing along said West line, 1317.86 feet; thence,
268) N 01°30'27" E, continuing along said West line, 450.42 feet; thence,
269) N 87°49'18" W, continuing along said West line and along a portion of the land described in the Grant Deed recorded March 25, 2014 as Instrument No. 2014011269 OR, 2634.75 feet to a point in the West line of Section 12, T27S, R15E, MDM; thence,
270) S 01° 37' 40" W, along said West line of Section 12, a distance of 446.97 feet to the Northwest corner of the Southwest one-quarter of the Southwest one-quarter of said Section 12; thence,
271) S 87° 44' 49" E, along the North line of said Southwest one-quarter of the Southwest one-quarter, 1,317.87 feet to the Northeast corner thereof; thence,
272) S 01° 34' 03" W, along the East line of said Southwest one-quarter of the Southwest one-quarter, a distance of 1,342.45 feet to the Northeast corner of the Northwest one-quarter of the Northwest one-quarter of Section 13 T27S, R15E, MDM; thence,
273) S 01° 36' 29" W, along the East line of said Northwest one-quarter of the Northwest one-quarter, 1335.98 feet to the Southeast corner thereof, being a point in the exterior boundary of the land described in the Grant Deed recorded December 28, 2010 as

- Instrument No. 2010066708 OR, records of said County and State; thence, continuing along said exterior boundary,
- 274) S 87° 49' 26" E, a distance of 3,963.71 feet to the Southeast corner of the Northeast one-quarter of the Northeast one-quarter of said Section 13; thence,
 - 275) S 01° 21' 05" W, along the East line of said Section 13, a distance of 2,664.90 feet to the Northwest corner of the Southwest one-quarter of the Southwest one-quarter of Section 18, T27S, R16E, MDM; thence,
 - 276) S 88° 17' 19" E, along the North line of the South one-half of the South one-half of said Section 18, a distance of 4,035.22 feet to the Northwest corner of the Southeast one-quarter of the Southeast one-quarter of said Section 18; thence,
 - 277) S 02° 54' 17" W, along the West line of said Southeast one-quarter of the Southeast one-quarter, a distance of 1,320.69 feet to the Southwest corner thereof; thence,
 - 278) S 88° 21' 05" E, along the South line of said Section 18, a distance of 1,339.66 feet to the Northerly corner common to Sections 19 and 20; thence,
 - 279) S 88°18'53" E, along the North line of said Section 20, a distance of 1336.35 feet to the Northwest corner of the Northeast one-quarter of the Northwest one-quarter of said Section 20; thence,
 - 280) S 01°51'53" W, 1332.30 feet to the Southwest corner of said Northeast one-quarter of said Northwest one-quarter; thence,
 - 281) S 88°18'07" E, 1333.76 feet to the Southeast corner said Northeast one-quarter of said Northwest one-quarter; thence,
 - 282) S 01°58'33" W, 1332.60 feet to the Center of said Section 20; thence,
 - 283) S 88°16'55" E, 2662.20 feet to the one-quarter corner common to Section 20 and Section 21; thence,
 - 284) S 87° 33' 57" E, along the East/West midline of said Section 21, a distance of 1,335.53 feet to the Northeast corner of the West one-half of the Southwest one-quarter of said Section 21; thence,
 - 285) S 02° 06' 24" W, along the East line of said West one-half of the Southwest one-quarter, a distance of 2,650.75 feet to the Southeast corner of said West one-half of the Southwest one-quarter; thence,
 - 286) S 88° 15' 56" E, along the North line of Section 28, a distance of 1,339.95 feet to the North one-quarter corner of said Section 28; thence,
 - 287) S 01° 49' 48" W, along the North/South midline of said Section 28, a distance of 1,359.38 feet to the Northwest corner of the Southwest one-quarter of the Northeast one-quarter of said Section 28; thence,
 - 288) S 87° 50' 37" E, along the North line of said Southwest one-quarter of the Northeast one-quarter, 1,330.53 feet to the Northwest corner of the Southeast one-quarter of the Northeast one-quarter of said Section 28; thence,
 - 289) S 01° 47' 15" W, along the West line of said Southeast one-quarter of the Northeast one-quarter, 1338.17 feet to the Northwest corner of the East one-half of the Southeast one-quarter of said Section 28; thence,
 - 290) S 87° 51' 57" E, along the North line of said East one-half of the Southeast one-quarter, 1,331.49 feet to the common quarter corner to Section 28 and Section 27; thence,
 - 291) S 87° 29' 13" E, along the East/West midline of said Section 27, a distance of 1,332.10 feet to the Northeast corner of the West one-half of the Southwest one-quarter of Section 27; thence,
 - 292) S 01° 44' 31" W, along the East line of said West one-half of said Southwest one-quarter, a distance of 1,334.59 feet to Northwest corner of the Southeast one-quarter of the Southwest one-quarter of said Section 27; thence,

- 293) S 87° 37' 03" E, along the North line of said Southeast one-quarter of the Southwest one-quarter, a distance of 1,332.15 feet to the Northeast corner thereof; thence,
- 294) S 01° 44' 15" W, along the East line of said Southeast one-quarter of the Southwest one-quarter of said Section 27, a distance of 1,331.69 feet to the one-quarter corner common to Section 27 and 34; thence,
- 295) S 43° 17' 17" E, 3,775.23 feet to the one-quarter corner common to Section 34 and Section 35; thence,
- 296) S 01° 36' 08" W, along the common line to said Section 34 and 35, a distance of 2,642.75 feet to the corner common to Section 34, 35, T27S, R16E, MDM, and Section 2 and 3 T28S, R16E, MDM; thence,
- 297) S 01° 19' 40" W, along the common line to said Section 3 and 2, a distance of 525.69 feet to the Northeast corner of Parcel 12 of Parcel Map No. COAL 85-030 recorded in Parcel Map Book 37, Page 81; thence, along the exterior boundary of Parcels 12, 11, 13 of said Parcel Map; the following 12 courses,
- 298) S 01° 19' 40" W, 2,753.23 feet; thence,
- 299) S 41° 00' 12" E, 430.82 feet; thence,
- 300) N 36° 44' 48" E, 318.12 feet; thence,
- 301) N 72° 29' 48" E, 232.32 feet; thence,
- 302) S 82° 15' 12" E, 71.28 feet; thence,
- 303) S 52° 00' 12" E, 486.42 feet; thence,
- 304) S 88° 29' 48" E, 1,498.93 feet to the Northeast corner of the Southeast one-quarter of the Southwest one-quarter of said Section 2; thence,
- 305) S 01° 23' 16" W, 1,300.23 feet to the one-quarter corner common to Section 2 and Section 11; thence,
- 306) S 88° 12' 38" E, 1,324.06 feet to Northwest corner of the Northeast one-quarter of the Northeast one-quarter of said Section 11; thence,
- 307) S 01° 20' 09" W, 1,342.80 feet to the Southwest corner of said Northeast one-quarter of the Northeast one-quarter; thence,
- 308) S 88° 36' 59" E, 1,325.69 feet to the Southeast corner of said Northeast one-quarter of said Northeast one-quarter; thence,
- 309) S 01° 15' 46" W, 4000.44 feet to the corner common to Sections 11, 12, 13 and 14; thence,
- 310) S 01° 21' 45" W, 680.05 feet to the Easterly corner common to Parcels 13 and 3 of said Parcel Map; thence, along the Easterly line of Parcels 3 and 1 of said Parcel Map,
- 311) S 01° 21' 45" W, 2,314.88 feet; thence,
- 312) N 89° 21' 49" E, 221.76 feet; thence,
- 313) S 15° 38' 11" E, 118.80 feet; thence,
- 314) S 53° 51' 49" W, 323.13 feet; thence,
- 315) S 01° 21' 49" W, 2,049.96 feet to an angle point; thence,
- 316) S 4500'00" W, 99.00 feet to an angle point in the southerly line of said Parcel 1; thence,
- 317) N 87° 50' 12" W, along the South line of said Parcel 1, a distance of 125.50 feet to the Northeast corner of the land described in the Grant Deed recorded April 24, 2003 as Instrument No. 2003043505 OR; thence, along the Easterly line of the land described in said Grant Deed the following 74 courses,
- 318) S 49° 31' 13" W, 882.88 feet; thence,
- 319) N 62° 14' 53" W, 267.45 feet; thence,
- 320) N 84° 17' 21" W, 177.56 feet; thence,
- 321) S 82° 02' 19" W, 201.37 feet; thence,
- 322) S 19° 43' 17" W, 215.90 feet; thence,

323) S 18° 36' 11" E, 209.95 feet; thence,
324) S 14° 12' 45" W, 178.38 feet; thence,
325) S 62° 26' 09" W, 300.23 feet; thence,
326) S 33° 32' 39" W, 453.70 feet; thence,
327) S 46° 20' 35" E, 972.04 feet; thence,
328) S 35° 02' 12" W, 184.20 feet; thence,
329) N 49° 14' 02" W, 638.59 feet; thence,
330) S 17° 33' 51" W, 575.68 feet; thence,
331) S 74° 23' 19" W, 562.86 feet; thence,
332) N 39° 45' 12" W, 337.84 feet; thence,
333) S 81° 47' 36" W, 446.05 feet; thence,
334) S 19° 26' 40" W, 226.23 feet; thence,
335) S 27° 45' 20" E, 155.22 feet; thence,
336) S 21° 11' 44" W, 546.50 feet; thence,
337) S 13° 19' 51" W, 253.32 feet; thence,
338) S 80° 11' 43" W, 211.01 feet; thence,
339) S 30° 07' 29" W, 373.29 feet; thence,
340) S 65° 02' 27" E, 305.12 feet; thence,
341) S 05° 21' 46" W, 237.26 feet; thence,
342) S 00° 01' 32" W, 763.97 feet; thence,
343) S 76° 17' 01" E, 282.94 feet; thence,
344) S 01° 08' 04" W, 140.21 feet; thence,
345) S 59° 16' 22" W, 287.91 feet; thence,
346) S 09° 56' 35" E, 325.58 feet; thence,
347) N 83° 36' 32" E, 97.37 feet; thence,
348) S 03° 08' 55" E, 885.80 feet; thence,
349) S 87° 41' 07" E, 395.09 feet; thence,
350) S 08° 02' 47" E, 544.05 feet; thence,
351) S 42° 36' 21" W, 278.85 feet; thence,
352) S 11° 53' 10" E, 449.19 feet; thence,
353) S 19° 29' 24" E, 527.77 feet; thence,
354) N 54° 10' 35" E, 246.71 feet; thence,
355) S 16° 44' 51" W, 539.46 feet; thence,
356) S 02° 19' 42" W, 135.67 feet; thence,
357) S 04° 03' 52" W, 554.55 feet; thence,
358) S 05° 34' 35" W, 348.01 feet; thence,
359) S 79° 01' 57" E, 161.61 feet; thence,
360) S 05° 02' 59" W, 545.77 feet; thence,
361) S 08° 10' 54" E, 559.14 feet; thence,
362) S 05° 35' 22" E, 444.37 feet; thence,
363) S 13° 02' 09" W, 640.37 feet; thence,
364) S 23° 30' 03" W, 342.41 feet; thence,
365) S 11° 41' 17" W, 472.74 feet; thence,
366) S 65° 35' 27" E, 175.84 feet; thence,
367) S 07° 07' 22" W, 616.62 feet; thence,
368) S 33° 43' 45" E, 219.25 feet; thence,
369) S 08° 41' 38" W, 435.68 feet; thence,
370) S 18° 45' 51" W, 328.39 feet; thence,
371) S 31° 45' 25" W, 601.64 feet; thence,

- 372) S 02° 33' 29" W, 350.17 feet; thence,
373) S 39° 53' 51" W, 762.79 feet; thence,
374) S 04° 38' 16" E, 989.32 feet; thence,
375) S 88° 06' 57" E, 337.43 feet; thence,
376) S 28° 06' 18" E, 340.78 feet; thence,
377) S 79° 13' 49" E, 115.91 feet; thence,
378) S 79° 17' 15" E, 327.72 feet; thence,
379) S 07° 49' 07" W, 653.47 feet; thence,
380) S 52° 57' 45" W, 261.76 feet; thence,
381) S 32° 54' 41" W, 514.11 feet; thence,
382) S 10° 10' 01" E, 292.24 feet; thence,
383) S 26° 45' 32" E, 96.25 feet; thence,
384) S 23° 29' 05" E, 150.79 feet; thence,
385) S 21° 18' 28" W, 269.05 feet; thence,
386) S 31° 37' 15" E, 489.57 feet; thence,
387) S 38° 20' 39" E, 396.44 feet; thence,
388) S 17° 56' 51" W, 413.06 feet; thence,
389) S 13° 14' 45" W, 351.69 feet; thence,
390) S 77° 26' 00" W, 724.85 feet; thence,
391) S 41° 59' 53" W, 86.14 feet; thence,
392) S 23° 28' 35" E, 136.86 feet; thence,
393) S 02°08'48" W, 811.78 feet to a point on the Northerly right-of-way of State Highway 58 as shown on the Cal-Trans right-of-way map SLO-58-30.2; thence, along said right-of-way the following 6 courses,
394) N 52°29'16" W, 89.34 feet; thence,
395) N 10°58'47" E, 44.74 feet; thence,
396) N 52°23'59" W, 29.91 feet; thence,
397) S 64°06'05" W, 44.72 feet; thence,
398) N 52°29'04" W, 370.09 feet to the beginning of a curve concave southwesterly, having a radius of 1,550.00 feet, a delta angle of 38° 07' 28", the radial center of which bears S 37°31'22" W; thence,
399) Northwesterly along the arc of said curve 1031.36 feet to the North/South midline of Section 2, T29S, R16E, MDM; thence,
400) S 00°48'9" W, along said midline, 80.07 feet to a point on the Southerly right-of-way of said Highway 58, said point being the beginning of a curve concave southerly having a radius of 1,960.00 feet, a delta angle of 33° 29' 07", the radial center of which bears S 04°10'48" W; thence, along said Southerly right-of-way through Sections 2, 11, 10, 15, 16, 17, 8, 5, and 6 of said T29S, R16E, and through Sections 36 and 35 of T28S, R15E, MDM, the following 90 courses,
401) Southwesterly along the arc of said curve 1145.48 feet; thence,
402) S 60°41'41" W, 1,767.85 feet to the beginning of a curve concave southeasterly, having a radius of 960.00 feet, a delta angle of 16° 06' 00", the radial center of which bears S 29°18'19" E, thence,
403) Southwesterly along the arc of said curve 269.76 feet; thence,
404) S 44°35'41" W, 1,373.33 feet to the beginning of a curve concave southeasterly, having a radius of 1,960.00 feet, a delta angle of 11°11'00", the radial center of which bears S 45°24'19" E; thence,
405) Southwesterly along the arc of said curve 382.56 feet; thence,

- 406) S 33°24'41" W, 301.83 feet to the beginning of a curve concave northwesterly, having a radius of 2,040.00 feet, a delta angle of 22° 54' 00", the radial center of which bears N 56°35'19" W; thence,
- 407) Southwesterly along the arc of said curve 815.35 feet; thence,
- 408) S 56°18'41" W, 813.12 feet to the beginning of a curve concave southeasterly, having a radius of 960.00 feet, a delta angle of 24° 42' 00", the radial center of which bears S 33°41'19" W; thence,
- 409) Southwesterly along the arc of said curve 413.85 feet; thence,
- 410) S 31°36'41" W, 305.14 feet to the beginning of a curve concave northwesterly, having a radius of 2,040.00 feet, a delta angle of 09° 21' 00", the radial center of which bears N 58°23'19" W; thence,
- 411) Southwesterly along the arc of said curve 332.90 feet; thence,
- 412) S 40°57'41" W, 236.89 feet to the beginning of a curve concave northwesterly, having a radius of 740.00 feet, a delta angle of 34° 00' 00", the radial center of which bears N 49°02'19" W; thence,
- 413) Southwesterly along the arc of said curve 439.12 feet; thence,
- 414) S 74°57'41" W, 317.34 feet to the beginning of a curve concave southeasterly, having a radius of 1,460.00 feet, a delta angle of 09° 16' 00", the radial center of which bears S 15°02'19" E; thence,
- 415) Southwesterly along the arc of said curve 236.13 feet; thence,
- 416) S 65°41'41" W, 91.62 feet to the beginning of a curve concave southeasterly, having a radius of 960.00 feet, a delta angle of 16° 20' 00", the radial center of which bears S 24°19'19" E; thence,
- 417) Southwesterly along the arc of said curve 273.67 feet; thence,
- 418) S 49°21'41" W, 532.96 feet to the beginning of a curve concave northwesterly, having a radius of 2,040.00 feet, a delta angle of 05° 19' 00", the radial center of which bears N 40°38'19" W; thence,
- 419) Southwesterly along the arc of said curve 189.30 feet; thence,
- 420) S 54°40'41" W, 162.44 feet to the beginning of a curve concave southeasterly, having a radius of 1,460.00 feet, a delta angle of 07° 42' 00", the radial center of which bears S 35°19'19" E; thence,
- 421) Southwesterly along the arc of said curve 196.21 feet; thence,
- 422) S 46°58'41" W, 30.72 feet to the beginning of a curve concave northwesterly, having a radius of 740.00 feet, a delta angle of 18° 01' 00", the radial center of which bears N 43°01'19" W; thence,
- 423) Southwesterly along the arc of said curve 232.69 feet; thence,
- 424) S 64°59'41" W, 103.11 feet to the beginning of a curve concave southeast, having a radius of 1,460.00 feet, a delta angle of 06° 55' 00", the radial center of which bears S 25°00'19" E; thence,
- 425) Southwesterly along the arc of said curve 176.25 feet; thence,
- 426) S 58°4'41" W, 146.08 feet to the beginning of a curve concave southeasterly, having a radius of 2,960.00 feet, a delta angle of 03° 46' 00", the radial center of which bears S 31°55'19" E; thence,
- 427) Southwesterly along the arc of said curve 194.59 feet; thence,
- 428) S 54°18'41" W, 209.12 feet to the beginning of a curve concave southeasterly, having a radius of 960.00 feet, a delta angle of 09° 11' 00", the radial center of which bears S 35°41'19" E; thence,
- 429) Southwesterly along the arc of said curve 153.87 feet; thence,

- 430) S 45°07'41" W, 78.69 feet to the beginning of a curve concave northerly, having a radius of 690.00 feet, a delta angle of 54° 35' 00", the radial center of which bears N44°52'19" W; thence,
- 431) Southwesterly and westerly along the arc of said curve 657.33 feet; thence,
- 432) N 80°17'19" W, 686.15 feet to the beginning of a curve concave southerly, having a radius of 2960.00 feet, a delta angle of 15° 17' 00", the radial center of which bears S 09°42'41" W; thence,
- 433) Westerly along the arc of said curve 789.56 feet; thence,
- 434) S 84°25'41" W, 3,947.91 feet to the beginning of a curve concave northeasterly, having a radius of 640.00 feet, a delta angle of 88° 10' 00", the radial center of which bears N 05°34'19" W; thence,
- 435) Southwesterly and northerly along the arc of said curve 984.83 feet; thence,
- 436) N 07°24'19" W, 137.12 feet to the beginning of a curve concave easterly, having a radius of 1,040.00 feet, a delta angle of 11° 12' 00", the radial center of which bears N 82°35'41" E; thence,
- 437) Northerly along the arc of said curve 203.30 feet; thence,
- 438) N 03°47'41" E, 102.74 feet to the beginning of a curve concave easterly, having a radius of 840.00 feet, a delta angle of 13° 17' 00", the radial center of which bears S 86°12'19" E; thence,
- 439) Northerly along the arc of said curve 194.74 feet; thence,
- 440) N 17°04'41" E, 20.03 feet to the beginning of a curve concave westerly, having a radius of 960.00 feet, a delta angle of 16° 40' 00", the radial center of which bears N 72°55'19" W; thence,
- 441) Northerly along the arc of said curve 279.25 feet; thence,
- 442) N 00°24'41" E, 356.85 feet to the beginning of a curve concave westerly, having a radius of 960.00 feet, a delta angle of 24° 38' 00", the radial center of which bears N 89°35'19" W; thence,
- 443) Northerly along the arc of said curve 412.74 feet; thence,
- 444) N 24°13'19" W, 64.82 feet to the beginning of a curve concave northeasterly, having a radius of 1,040.00 feet, a delta angle of 11° 50' 00", the radial center of which bears N 65°46'41" E; thence,
- 445) Northerly along the arc of said curve 214.79 feet; thence,
- 446) N 12°23'19" W, 73.45 feet to the beginning of a curve concave northeasterly, having a radius of 1,040.00 feet, a delta angle of 13° 34' 00", the radial center of which bears N 77°36'41" E; thence,
- 447) Northerly along the arc of said curve 246.26 feet; thence,
- 448) N 01°10'41" E, 822.07 feet to the beginning of a curve concave easterly, having a radius of 540.00 feet, a delta angle of 24° 04' 00", the radial center of which bears S 88°49'19" E; thence,
- 449) Northerly along the arc of said curve 226.82 feet; thence,
- 450) N 25°14'41" E, 175.19 feet to the beginning of a curve concave westerly, having a radius of 460.00 feet, a delta angle of 66° 40' 00", the radial center of which bears N 64°45'19" W; thence,
- 451) Northerly along the arc of said curve 535.23 feet; thence,
- 452) N 41°25'19" W, 690.73 feet to the beginning of a curve concave southwesterly, having a radius of 5,960.00 feet, a delta angle of 03° 20' 30", the radial center of which bears S 48°34'41" W; thence,
- 453) Northwesterly along the arc of said curve 347.61 feet; thence,

- 454) N 44°45'49" W, 335.23 feet to the beginning of a curve concave northeasterly, having a radius of 1,040.00 feet, a delta angle of 31° 31' 00", the radial center of which bears N 45°14'11" E; thence,
- 455) Northwesterly along the arc of said curve 572.07 feet; thence,
- 456) N 13°14'49" W, 553.05 feet to the beginning of a curve concave southwesterly, having a radius of 1,960.00 feet, a delta angle of 11° 52' 30", the radial center of which bears S 76°45'11" W; thence,
- 457) Northwesterly along the arc of said curve 406.23 feet; thence,
- 458) N 25°07'19" W, 1265.83 feet to the beginning of a curve concave easterly, having a radius of 540.00 feet, a delta angle of 05° 49' 33", the radial center of which bears N 64°52'41" E; thence,
- 459) N 21° 41' 13" W, 52.52 feet to the beginning of a curve concave easterly having a radius of 1050.00 feet, a delta angle of 27°58'45", the radial center of which bears N 73°12'42" E; thence,
- 460) Northwesterly along the arc of said curve 512.75 feet; thence,
- 461) N 11°11'27" E, 412.82 feet to the beginning of a curve concave westerly having a radius of 650.00 feet, a delta angle of 04° 14' 12", the radial center of which bears N 78°48'33" W; thence,
- 462) Northwesterly along the arc of said curve 48.06 feet; thence,
- 463) N08°59'35" W, 96.65 feet to the beginning of a curve concave southwesterly having a radius of 660.00 feet, a delta of 70°47'39", the radial center of which bears N81°00'25"W, thence,
- 464) Northwesterly along the arc of said curve 815.49 feet; thence,
- 465) N 67°56'42" W, 430.59 feet; to the beginning of a curve concave northeasterly, having a radius of 740.00 feet, a delta angle of 30° 25' 00", the radial center of which bears N 29°10'41" E; thence,
- 466) Northwesterly along the arc of said curve 392.84 feet; thence,
- 467) N 30°24'19" W, 144.09 feet to the beginning of a curve concave southwesterly, having a radius of 460.00 feet, a delta angle of 39° 55' 00", the radial center of which bears S 59°35'41" W; thence,
- 468) Northwesterly along the arc of said curve 320.47 feet; thence,
- 469) N 70°19'19" W, 679.48 feet to the beginning of a curve concave northeasterly, having a radius of 840.00 feet, a delta angle of 30° 57' 00", the radial center of which bears N 19°40'41" E; thence,
- 470) Northwesterly along the arc of said curve 453.75 feet; thence,
- 471) N 39°22'19" W, 342.97 feet to the beginning of a curve concave northeasterly, having a radius of 1,040.00 feet, a delta angle of 25° 13' 00", the radial center of which bears N 50°37'41" E; thence,
- 472) Northwesterly along the arc of said curve 457.72 feet; thence,
- 473) N 14°09'19" W, 229.67 feet to the beginning of a curve concave westerly, having a radius of 460.00 feet, a delta angle of 44° 24' 30", the radial center of which bears S 75°50'41" W; thence,
- 474) Northwesterly along the arc of said curve 356.53 feet; thence,
- 475) N 58°33'49" W, 2673.73 feet to the beginning of a curve concave northeasterly, having a radius of 2,040.00 feet, a delta angle of 17° 36' 00", the radial center of which bears N 31°26'11" E; thence,
- 476) Northwesterly along the arc of said curve 626.64 feet; thence,

- 477) N 40°57'49" W, 741.12 feet to the beginning of a curve concave northeasterly, having a radius of 2,540.00 feet, a delta angle of 27° 03' 00", the radial center of which bears N 49°02'11" E; thence,
- 478) Northwesterly along the arc of said curve 1199.16 feet; thence,
- 479) N 13°54'49" W, 312.82 feet to the beginning of a curve concave southwesterly, having a radius of 1,960.00 feet, a delta angle of 12° 02' 00", the radial center of which bears S 76°05'11" W; thence,
- 480) Northwesterly along the arc of said curve 411.64 feet; thence,
- 481) N 25°56'49" W, 467.58 feet to the beginning of a curve concave southwesterly, having a radius of 460.00 feet, a delta angle of 30° 33' 00", the radial center of which bears S 64°03'11" W; thence,
- 482) Northwesterly along the arc of said curve 245.27 feet; thence,
- 483) N 56°29'49" W, 12.94 feet to the beginning of a curve concave northeasterly, having a radius of 1,040.00 feet, a delta angle of 15° 29' 00", the radial center of which bears N 33°30'11" E; thence,
- 484) Northwesterly along the arc of said curve 281.04 feet; thence,
- 485) N 41°00'49" W, 492.42 feet to the beginning of a curve concave northeasterly, having a radius of 2,040.00 feet, a delta angle of 16° 29' 00", the radial center of which bears N 48°59'11" E; thence,
- 486) Northwesterly along the arc of said curve 586.88 feet; thence,
- 487) N 24°31'49" W, 181.72 feet to the beginning of a curve concave southwesterly, having a radius of 960.00 feet, a delta angle of 27° 24' 00", the radial center of which bears S 65°28'11" W; thence,
- 488) Northwesterly along the arc of said curve 459.09 feet; thence,
- 489) N 51°55'49" W, 421.04 feet to the beginning of a curve concave southwesterly, having a radius of 1,460.00 feet, a delta angle of 22° 07' 00", the radial center of which bears S 38°04'11" W; thence,
- 490) Northwesterly along the arc of said curve 563.57 feet; thence,
- 491) N 74°02'49" W, 164.98 feet to the beginning of a curve concave southwesterly, having a radius of 523.80 feet, a delta angle of 36° 23' 03", the radial center of which bears S 15°57'11" W; thence,
- 492) Northwesterly and southwesterly along the arc of said curve 323.63 feet; thence,
- 493) S 69°34'08" W, 50.87 feet to a point on the East line of the Northwest one-quarter of the Northeast one-quarter of said Section 35, T28S, R15E; thence,
- 494) S 01°39'09" W, 1,094.59 feet to the Southeast corner of said Northwest one-quarter of the Northeast one-quarter; thence,
- 495) N 88°29'22" W, 1,336.61 feet to the Southwest corner of said Northwest one-quarter of the Northeast one-quarter; thence,
- 496) S 01°38'13" W, 1,299.38 feet to the center of said Section 35; thence,
- 497) N 88°33'28" W, 2,674.44 feet to the one-quarter corner common to Section 35 and Section 34; thence,
- 498) S 01°38'50" W, 2,605.06 feet to the Southeast corner of said Section 34, said corner also being a point in the Northerly line of the land described in the Grant Deed recorded February 16, 2011 as Instrument No. 201108346 OR; thence, along the exterior boundary of said Grant Deed 201108346 OR,
- 499) S 88°43'48" E, 2575.81 feet to the Northeast corner thereof; thence,
- 500) S 01°18'47" W, 1015.00 feet to the Southeast corner thereof; thence,
- 501) N 88°34'14" W, 4156.06 feet to a point in the East line of Section 3, T29S, R15E, MDM; thence,

- 502) N 88°11'45" W, continuing along said exterior boundary, 1319.88 feet to the Southwest corner thereof; thence,
- 503) N 01°36'29" E, 997.52 feet to the Northwest corner of the land described in said Grant Deed 201108346 OR; thence,
- 504) N 88°23'31" W, 2496.47 feet to an angle point; thence,
- 505) N 02°16'40" E, 5280.00 feet to the corner common to Sections 34, 33, 28 and 27; thence,
- 506) N 01°42'37" E, 5,271.30 feet to the corner common to Sections 27, 28, 21, and 22; thence,
- 507) N 01°44'43" E, 2,641.37 feet to the one-quarter corner common to Sections 22 and 21, said corner being a point in the exterior boundary of the land described in the Trustee's Quitclaim Deed recorded December 11, 2001 as Instrument No. 2001095664 OR; thence, along said exterior boundary the following 106 courses,
- 508) N 90°00'00" W, 2,658.07 feet to the center of said Section 21; thence,
- 509) S 01°45'45" W, 1276.51 feet to the Northeast corner of the South one-half of the Southwest one-quarter of said Section 21; thence,
- 510) N 89°02'41" W 2666.65 feet to the Northwest corner of said South one-half; thence,
- 511) S 01°22'16" W along the line common to Sections 21 and 20, 1309.80 feet to the Southeast corner of said Section 20, T28S, R15E, MDM, thence,
- 512) N 88°17'33" W along the South line of said Section 20, a distance of 1275.30 feet to the Southwest corner of the East one-half of the Southeast one-quarter of said Section 20; thence,
- 513) N 00°55'59" E along the West line of said East one-half, 2613.46 feet to the Northwest corner of said East one-half; thence,
- 514) N 88°34'17" W along the East/West midline of said Section 20, a distance of 1308.06 feet to the center of said Section 20; thence,
- 515) N 00°12'40" E along the North/South midline of said Section 20, a distance of 2627.27 feet to the one-quarter corner common to Section 20 and 17; thence,
- 516) N 02°01'37" E along the North/South midline of said Section 17, a distance of 2699.19 feet to the Center of said Section 17; thence,
- 517) N 02°01'33" E, 2,744.86 feet to the one-quarter corner common to Sections 17 and 8; thence,
- 518) N 88°17'51" W, 2,676.61 feet to the Southerly corner common to Sections 8 and 7; thence,
- 519) S 89°07'48" W, 2,614.71 feet to the one-quarter corner common to Section 7 and 18; thence,
- 520) S 01°39'36" W, 2,696.91 feet to the center of said Section 18; thence,
- 521) N 88°38'13" W, 2,709.01 feet to the one-quarter corner common to Sections 18, T28S, R15E, MDM and Section 13, T28S, R14E, MDM; thence,
- 522) N 01°39'30" E, 2,662.94 feet to the Southerly corner common to Sections 7, T28S, R15E, MDM and Section 12, T28S, R14E, MDM; thence,
- 523) N 88°52'47" W, 5,361.52 feet to the Southerly corner common to Sections 12 and 11; thence,
- 524) N 88°38'10" W, 5,322.86 feet to the Southerly corner common to Sections 11 and 10; thence,
- 525) N 01°59'37" E, 5,273.50 feet to the Southerly corner common to Sections 2 and 3; thence,
- 526) N 01°39'50" E, 5,474.89 feet to the Northerly corner common to Section 2 and 3 and the Southerly corner common to Section 35 and 34, T27S, R14E, MDM; thence,

- 527) N 00°57'12" E, 5,291.63 feet to the Northerly corner common to Section 35 and 34; thence,
- 528) N 88°38'00" W, 3,743.95 feet; thence,
- 529) N 28°42'58" E, 1,550.17 feet; thence,
- 530) N 22°37'58" E, 988.40 feet to a point on the North/South midline of Section 27; thence,
- 531) N 00°53'20" E, 390.25 feet to the center of said Section 27; thence,
- 532) N 00°53'20" E, 1,280.59 feet to the Northwest corner of the Southwest one-quarter of the Northeast one-quarter of said Section 27; thence,
- 533) S 88°35'29" E, 1,323.21 feet to the Northeast corner of said Southwest one-quarter of the Northeast one-quarter of said Section 27; thence,
- 534) N 00°50'00" E, 1,322.56 feet to the Southwest corner of the Southeast one-quarter of the Southeast one-quarter of Section 22; thence,
- 535) N 01°45'06" E, 1,289.17 feet to the Northwest corner of said Southeast one-quarter of the Southeast one-quarter of Section 22, being the Southwest corner of Lot 148 of Associated Almonds Orchards Map recorded in Map Book 2, Page 31; thence, along the Southwesterly line of said Lot 148,
- 536) N 20°12'59" W, 1,058.67 feet to the center of a 40 foot wide road, thence, along the centerline of said road,
- 537) S 27°09'01" W, 100.00 feet; thence,
- 538) S 47°32'01" W, 100.00 feet to an intersection with the Southeasterly prolongation of the Southwesterly line of Lot 147 of said Associated Almonds Orchards Map; thence,
- 539) N 66°24'24" W, along said Southwesterly line and its Northwesterly prolongation 569.80 feet to the centerline of 40 foot wide road shown on said map; thence, along the centerline of said road the following 9 courses,,
 - 540) N 28°44'31" E, 291.13 feet; thence,
 - 541) N 26°48'01" E, 415.00 feet; thence,
 - 542) N 26°48'01" E, 363.45 feet; thence,
 - 543) N 41°12'01" E, 400.32 feet; thence,
 - 544) N 49°25'01" E, 300.00 feet; thence,
 - 545) N 55°40'01" E, 61.00 feet; thence,
 - 546) N 55°40'01" E, 114.00 feet; thence,
 - 547) N 61°59'01" E, 75.00 feet; thence,
 - 548) N 78°56'01" E, 140.00 feet to an intersection with the Southeasterly prolongation of the Southwesterly line of Lot 154; thence,
- 549) N 39°09'59" W, 242.70 feet to the Northwest corner of said Lot 154 and the Southeast corner of Lot 159; thence,
- 550) N 01°41'45" E, along the East line of Lots 159, 125, 116 and its Northerly prolongation, and Lot 146, a distance of 3,910.33 feet to a point in the Southerly Right-of-Way of the George F. Spurrier's Creston Shandon Road, currently State Highway 41; thence, along the Southerly Right of Way of said Highway 41, through Sections 15 and 16, the following 34 courses,
 - 551) N 70°36'56" W, 617.70 feet; thence,
 - 552) N 87°13'56" W, 158.10 feet; thence,
 - 553) N 63°46'56" W, 552.60 feet; thence,
 - 554) N 71°21'56" W, 300.00 feet; thence,
 - 555) N 81°36'56" W, 380.00 feet; thence,
 - 556) N 80° 49' 00" W, 230.00 feet; thence,
 - 557) S 81°22'04" W, 140.00 feet; thence,
 - 558) N 81°27'56" W, 408.00 feet; thence,

- 559) N 81°27'56" W, 17.00 feet; thence,
- 560) N 81°27'56" W, 140.00 feet; thence,
- 561) S 70°31'04" W, 155.00 feet; thence,
- 562) S 85°01'04" W, 128.50 feet; thence,
- 563) S 89°12'04" W, 185.00 feet; thence,
- 564) S 78°50'04" W, 370.00 feet; thence,
- 565) S 49°19'04" W, 130.00 feet; thence,
- 566) S 34°25'56" E, 290.00 feet; thence,
- 567) S 19°27'04" W, 130.00 feet; thence,
- 568) S 19°27'04" W, 230.00 feet; thence,
- 569) S 29°05'04" W, 307.08 feet; thence,
- 570) S 28°47'04" W, 85.00 feet; thence,
- 571) S 51°34'04" W, 480.10 feet; thence,
- 572) S 33°11'04" W, 385.50 feet; thence,
- 573) S 34° 37' 00" W, 49.50 feet; thence,
- 574) S 49°11'04" W, 126.80 feet; thence,
- 575) S 69°20'04" W, 425.00 feet; thence,
- 576) S 69°20'04" W, 146.00 feet; thence,
- 577) N 78°30'56" W, 217.20 feet; thence,
- 578) N 39°51'56" W, 152.00 feet; thence,
- 579) S 69°22'04" W, 319.90 feet; thence,
- 580) S 61°14'04" W, 475.00 feet; thence,
- 581) S 61°14'04" W, 256.40 feet; thence,
- 582) S 47°29'04" W, 117.30 feet; thence,
- 583) S 36°34'04" W, 580.60 feet; thence,
- 584) S 36°34'04" W, 141.00 feet; thence,
- 585) S 37°38'04" W, 47.80 feet; thence,
- 586) S 13°20'56" E, 185.10 feet; thence,
- 587) S 35°54'56" E, 179.53 feet to a point in the Southerly line of said Section 16; thence, leaving said Southerly Right-of-Way,
- 588) N 88°29'00" W, 2,849.07 feet to the South corner common to Sections 16 and 17; thence,
- 589) N 87°34'50" W, 5,270.85 feet to the South corner common to Section 17 and 18; thence,
- 590) N 01°43'14" E, 2,638.28 feet to the one-quarter corner common to said Sections 17 and 18; thence,
- 591) N 87°29'59" W, 5,366.89 feet to the West one-quarter corner of said Section 18; thence,
- 592) N 01°29'55" E, 2,652.27 feet to the West corner common to Section 18 and Section 7 ; thence,
- 593) N 02°19'23" E, 2,664.61 feet to the one-quarter corner common to Section 7, T27S, R14E, MDM and Section 12, T27S, R13E, MDM; thence,
- 594) N 88°55'8" W, 5,314.96 feet to the one-quarter corner common to Section 12 and Section 11, T27S, R13E, MDM; thence,
- 595) N 02°20'37" E, 1,986.83 feet to the Northeast corner of Parcel 3 of Parcel Map CO 78-183 recorded in Parcel Map Book 29, Page 9; thence,
- 596) N 89°02'13" W, along the North line of Parcel 3 and the Easterly line of Parcel 2 of said Parcel Map, 2,664.90 feet; thence,
- 597) N 02°14'14" E, along a portion of the Easterly line of said Parcel 2 a distance of 656.85 feet to a point in the South line of Section 2, T27S, R13E, MDM; thence,
- 598) N 89°06'46" W, along the South line of Section 2 and Section 3, and along the North line of Parcel 2 and 1 of said Parcel Map, 5,300.76 feet to the Northwest corner of said Parcel

1, being the South corner common to Lots 1 and 2 as depicted on the Map of Survey of Lots 10 and 19 and Part of Lots 1 and 11 Rancho Huer Huero, filed in Book 14 of Licensed Surveys, Page 71 ; thence, along the common line to said Lots 1 and 2 of said Rancho Huer Huero the following 10 courses,

- 599) N 23°37'02" E, 199.98 feet; thence,
- 600) N 33°37'02" E, 181.50 feet; thence,
- 601) N 53°37'02" E, 414.48 feet; thence,
- 602) N 69°52'02" E, 463.32 feet; thence,
- 603) N 37°22'02" E, 1,276.44 feet; thence,
- 604) N 26°37'02" E, 620.40 feet; thence,
- 605) N 58°22'02" E, 249.48 feet; thence,
- 606) N 08°22'02" E, 598.62 feet; thence,
- 607) N 36°22'02" E, 1,180.74 feet; thence,
- 608) N 26°37'02" E, 1,470.71 feet to a point in the North line of Section 2, T27S, R13E, MDM; thence, leaving said common line to said Lots 1 and 2 of said Rancho Huer Huero,
- 609) S 88°54'19" E along the North line of said Section 2, a distance of 4477.90 feet to the Northerly corner common to Sections 2 and 1; thence,
- 610) S 01°42'51" W along the line common to said Section 2 and 1, a distance of 2694.70 feet to the one-quarter corner common to said Section 2 and 1; thence,
- 611) S 89°17'19" E along the East/West midline of said Section 1, a distance of 2656.34 feet to the center of said Section 1; thence,
- 612) N 01°57'09" E along the North/South midline of said Section 1, a distance of 2689.35 feet to the North one-quarter corner of said Section 1; thence,
- 613) S 88°27'22" E along the North line of said Section 1, a distance of 2661.23 feet to the corner common to said Section 1, T27S, R13E, and Section 6, T27S, R14E, MDM; thence,
- 614) S 88°06'57" E along the North line of said Section 6, a distance of 5366.32 feet to the North corner common to Section 6 and Section 5, T27S, R14E, MDM; thence,
- 615) S 87°46'19" E along the North line of said Section 5, a distance of 5267.91 feet to the North corner common to Section 5 and Section 4, T27S, R14E, MDM; thence,
- 616) S 88°05'07" E along the North line of said Section 4, a distance of 965.51 feet to the Southwest corner of the land described in the Deed of Trust recorded September 14, 2009 as Instrument No. 2009051027 OR; thence, departing the line of said Grant Deed 2001095664 OR and along the exterior boundary of the land described in said Deed of Trust 2009051027 OR, the following 53 courses
- 617) N 30°39'00" E, 278.00 feet; thence,
- 618) N 29°59'00" E, 408.00 feet; thence,
- 619) N 04°59'00" E, 136.00 feet; thence,
- 620) N 15°39'00" E, 357.00 feet; thence,
- 621) N 25°06'00" W, 300.00 feet; thence,
- 622) N 47°31'00" W, 65.00 feet; thence,
- 623) N 39°11'00" W, 270.00 feet; thence,
- 624) N 39°01'00" W, 139.00 feet; thence,
- 625) N 40°06'00" W, 239.00 feet; thence,
- 626) N 30°31'00" W, 358.00 feet; thence,
- 627) N 16°47'00" W, 127.00 feet; thence,
- 628) N 03°49'00" E, 86.00 feet; thence,
- 629) N 20°21'00" W, 342.00 feet; thence,

- 630) N 18°51'59" W, 407.00 feet; thence,
631) N 31°31'00" W, 99.00 feet; thence,
632) N 28°21'59" W, 175.00 feet; thence,
633) N 27°26'00" W, 327.00 feet; thence,
634) N 10°49'00" E, 98.00 feet; thence,
635) N 08°31'00" E, 114.00 feet; thence,
636) N 05°44'00" E, 143.00 feet; thence,
637) N 04°49'00" E, 163.00 feet; thence,
638) S 81°59'00" W, 22.60 feet; thence,
639) S 44°04'00" W, 258.00 feet; thence,
640) S 43°59'00" W, 170.00 feet; thence,
641) S 62°59'00" W, 827.00 feet; thence,
642) N 75°11'00" W, 323.00 feet; thence,
643) N 82°01'00" W, 229.00 feet; thence,
644) N 80°21'00" W, 306.00 feet; thence,
645) N 85°16'00" W, 121.00 feet; thence,
646) N 82°56'00" W, 180.00 feet; thence,
647) N 04°36'00" W, 225.00 feet; thence,
648) N 00°31'00" W, 406.00 feet; thence,
649) N 01°11'00" W, 212.00 feet; thence,
650) N 01°41'00" W, 136.00 feet; thence,
651) N 03°36'00" E, 341.00 feet; thence,
652) N 03°59'00" E, 68.00 feet; thence,
653) N 52°19'00" E, 344.00 feet; thence,
654) N 14°34'00" E, 865.00 feet; thence,
655) N 18°59'00" E, 509.00 feet; thence,
656) N 00°31'00" W, 110.00 feet; thence,
657) N 29°59'00" E, 208.00 feet; thence,
658) N 35°21'00" W, 35.00 feet; thence,
659) N 44°41'00" W, 176.00 feet; thence,
660) N 57°29'00" E, 310.00 feet; thence,
661) N 50°49'00" E, 254.00 feet; thence,
662) N 12°59'00" E, 740.00 feet; thence,
663) N 83°55'22" E, 13.87 feet to the beginning of a curve concave westerly, having a radius of 305.62 feet, a delta angle of 10° 57' 03", the radial center of which bears N 85°32'35" W; thence,
664) Northerly along the arc of said curve a distance of 58.41 feet; thence;
665) N 06°29'28" W, 316.91 feet; thence,
666) S 88°29'00" W, 963.00 feet; thence,
667) N 75°31'00" W, 55.00 feet; thence,
668) N 08°14'00" E, 470.00 feet; thence,
669) N 18°34'00" E, 490.00 feet; thence,
670) N 19°34'00" E, 413.56 feet to a point in the exterior boundary of said Trustees Quitclaim Deed 2001095664 OR; thence, along the exterior boundary of said Trustees Quitclaim Deed 2001095664 OR, the following 15 courses,
671) N 87°33'29" W, 1,995.94 feet; thence,
672) N 87°44'48" W, 1315.35 feet; thence,
673) N 01°15'16" E, 1329.88 feet; thence,
674) N 14°38'36" W, 457.89 feet; thence,

- 675) N 08°06'37" E, 495.05 feet; thence,
676) N 09°47'24" W, 271.37 feet; thence,
677) N 42°00'00" W, 392.31 feet; thence,
678) N 29°45'47" W, 446.32 feet; thence,
679) N 36°43'12" W, 609.19 feet; thence,
680) N 36°37'38" W, 536.42 feet; thence,
681) N 18°43'14" W, 378.70 feet; thence,
682) N 43°07'13" E, 60.58 feet; thence,
683) N 38°15'44" E, 31.08 feet; thence,
684) N 35°10'56" E, 99.44 feet; thence,
685) S 16°28'22" E, 169.28 feet; thence,
686) N 64°27'54" E, 1065.73 feet; thence,
687) N 25°33'16" W, 500.09 feet to the beginning of a curve concave southeasterly, having a radius of 1170.00 feet, a delta angle of 00° 36' 53", the radial center of which bears S 27°41'40" E; thence,
688) Easterly along the arc of said curve 12.55 feet; thence, thence,
689) N 62°55'13" E 491.00 feet to the beginning of a curve concave southeasterly, having a radius of 1000.00 feet, a delta angle of 14° 15' 00", the radial center of which bears S 27°07'00" E; thence,
690) Easterly along the arc of said curve 248.71 feet; thence,
691) N 77°08'00" E, 20.28 feet to the beginning of a curve concave northwesterly, having a radius of 1000.00 feet, a delta angle of 24° 07' 00", the radial center of which bears N 12°52'00" W; thence,
692) Northeasterly along the arc of said curve 420.92 feet; thence,
693) N 53°01'00" E, 5.76 feet; thence, to the beginning of a curve concave northwesterly, having a radius of 800.00 feet, a delta angle of 24° 07' 00", the radial center of which bears N 36°59'00" W; thence,
694) Northeasterly along the arc of said curve 336.73 feet; thence,
695) N 28°54'00" E, 22.60 feet; thence,
N 28°54'00" E, 0.03 feet to the beginning of a curve concave southeasterly, having a radius of 400.00 feet, a delta angle of 53° 17' 00", the radial center of which bears S 61°06'00" E; thence,
696) Northeasterly along the arc of said curve 371.99 feet; thence, thence,
697) N 82°11'00" E, 0.03 feet; thence,
698) N 82°11'00" E, 889.50 feet; thence,
699) N 82°11'00" E, 122.90 feet; thence,
700) N 89°13'00" E, 122.90 feet to a point in the exterior boundary of the land described in the Grant Deed recorded December 19, 2013 as Instrument No. 2013068835 OR; thence, along said exterior boundary,
701) N 00°47'00" W, 70.00 feet; thence continuing along said exterior boundary.
702) N 11°48'00" W, 402.99 feet; thence continuing along said exterior boundary,
703) N 11°48'00" W, 2917.83 feet; thence continuing along said exterior boundary,
704) S 78°12'00" W, 1240.89 feet to a point in the exterior boundary of the land described in the Grant Deed recorded March 30, 1999 as Instrument No. 1999022507 OR; thence, along said exterior boundary the following 19 courses,
705) N 84°55'43" W, 1470.10 feet; thence,
706) S 74°13'17" W, 463.10 feet; thence,
707) N 72°55'28" W, 728.44 feet; thence,
708) S 10°39'00" W, 48.70 feet; thence,

- 709) S 79°21'00" W, 442.00 feet; thence,
710) S 85°18'42" W, 853.84 feet; thence,
711) S 48°19'42" W, 439.77 feet; thence,
712) S 27°56'42" W, 876.64 feet; thence,
713) S 48°05'47" W, 220.26 feet; thence,
714) S 37°50'30" E, 441.58 feet; thence,
715) S 37°12'19" E, 296.88 feet; thence,
716) S 33°01'12" E, 318.75 feet; thence,
717) S 31°36'22" E, 143.31 feet; thence,
718) S 33°14'36" E, 235.50 feet; thence,
719) S 31°55'40" E, 399.24 feet; thence,
720) S 32°34'32" E, 200.25 feet; thence,
721) S 30°33'53" E, 32.30 feet; thence,
722) S 29°57'00" E, 140.00 feet; thence,
723) S 39°02'00" W, 1049.80 feet; thence,
724) S 77°53'44" W, 2857.90 feet; thence,
725) N 01°18'45" E 1669.88 feet to the one-quarter corner common to Section 13 and 24, T26S, R13E, MDM, thence
726) N 87°34'30" W, 1322.08 feet to the Southeast corner of the West one-half of the Southwest one-quarter of said Section 13; thence,
727) N 01°34'41" E along the East line of said West one-half, 2662.54 feet to the Northeast corner of said West one-half; thence,
728) N 87°19'05" W along the North line of said West one-half, 1322.46 feet to the one-quarter corner common to Section 13 and 14; thence,
729) N 01°26'39" E along the common line to said Sections 13 and 14, a distance of 2663.95 feet to the corner common to Sections 13, 14, 11 and 12, T26S, R13E, MDM; thence,
730) N 00°57'35" E along the common line to said Sections 11 and 12, a distance of 5322.94 feet to the corner common to Sections 12, 11, 2 and 1, T26S, R13E, MDM; thence,
731) N 02°27'18" E along the line common to said Sections 1 and 2, a distance of 5190.64 feet to the corner common to said Sections 1 and 2, T26S, R13E, MDM and Sections 35 and 36, T25S, R13E, MDM; thence,
732) N 01°53'53" E along the line common to said Sections 35 and 36, a distance of 5290.88 feet to the corner common to Sections 36, 35, 26 and 25, T25S, R13E, MDM; thence,
733) N 01°43'00" E along the line common to said Sections 25 and 26, a distance of 5258.99 feet; thence,
734) S 87°40'20" E along the line common to Sections 24 and 25, a distance of 2666.92 feet to the one-quarter corner common to said Sections 24 and 25; thence,
735) N 01°36'34" E along the North/South midline of said Section 24, a distance of 5315.56 feet to the one-quarter corner common to Section 24 and 13; thence,
736) N 01°38'26" E 1325.61 to the Northeast corner of the Southeast one-quarter of the Southwest one-quarter of said Section 13, said corner also being a point in the exterior boundary of the land described in the Grant Deed recorded January 13, 2004 as Instrument No. 2004002199 OR; thence,
737) N 87°48'04" W, along said exterior boundary, 800.00 feet; thence, thence,
738) N 42°53'50" E, along said exterior boundary 5264.53 feet to the corner common to Sections 13 and 12, T 25S, R13E, and Sections 7 and 18, T25S, R14E, MDM; thence, leaving said exterior boundary,
739) S 88°33'15" E along the line common to said Sections 7 and 18, a distance of 5247.22 feet to the corner common to Sections 18, 7, 8, and 17, T25S, R14E, MDM; thence,

- 740) N 01°31'48" E, along the line common to said Sections 7 and 8, a distance of 5304.33 feet to the corner common to Sections 8, 7, 6 and 5; thence,
- 741) S 87°53'36" W along the line common to said Sections 5 and 8, a distance of 2789.69 feet to a point in the exterior boundary of the land described in said Grant Deed recorded October 6, 2016 as Instrument No. 2016050847 OR; thence, along said exterior boundary the following 30 courses,
- 742) N 18°53'30" E 158.93 feet; thence,
- 743) N 19°17'20" E, 451.95 feet; thence,
- 744) N 22°34'50" E, 194.33 feet; thence,
- 745) N 43°15'00" E, 98.76 feet; thence,
- 746) N 73°23'00" E, 219.68 feet; thence,
- 747) N 41°23'00" E, 365.78 feet; thence,
- 748) N 37°02'40" E, 204.89 feet; thence,
- 749) N 20°02'50" E, 357.05 feet; thence,
- 750) N 21°47'50" E, 128.78 feet; thence,
- 751) N 23°06'40" E, 205.80 feet; thence,
- 752) N 00°29'10" W, 155.07 feet; thence,
- 753) N 01°26'10" W, 113.08 feet; thence,
- 754) N 00°11'10" W, 321.83 feet; thence,
- 755) N 27°53'30" W, 311.02 feet; thence,
- 756) N 20°31'20" W, 118.64 feet; thence,
- 757) N 21°17'40" E, 152.26 feet; thence,
- 758) N 58°01'30" E, 122.03 feet; thence,
- 759) N 13°59'20" E, 390.63 feet; thence,
- 760) N 20°09'20" E, 103.16 feet; thence,
- 761) N 20°09'20" E, 441.20 feet; thence,
- 762) N 53°39'40" E, 190.51 feet; thence,
- 763) N 14°29'30" E, 981.23 feet; thence,
- 764) N 14°47'30" E, 190.58 feet; thence,
- 765) S 83°06'59" W, 45.23 feet; thence,
- 766) S 56°25'29" W, 177.91 feet; thence,
- 767) S 66°15'29" W, 100.36 feet; thence,
- 768) S 48°15'39" W, 174.30 feet; thence,
- 769) S 80°29'59" W, 176.80 feet thence,
- 770) N 41°39'51" W, 230.59 feet thence,
- 771) N 52°07'01" W, 233.81 feet to a point in the North line of said Section 5; thence,
- 772) S 88°26'06" E along said North line, 1710.55 feet to the Point of Beginning;

Containing 151,732.2 acres +/-

EXCEPTING THEREFROM within the confines of the afore described boundary:

- A) Any portion thereof lying within the variable width right-of-way of State Highway 41 as it exists as of the date of this description and any future modifications.
- B) All that portion of land described in the Quitclaim Deed recorded March 30, 2007 as Instrument No. 2007021476 OR, records of said County and State, containing 4,308.4 acres +/-.

- C) Lots 1 through 39 as depicted on the Map of the Sheid Ranchō recorded in Map Book 2, Page 53, records of said County and State, and the land described in the Grant Deed recorded May 11, 2017 as Instrument No., 2017020512 OR, containing 473.0 acres +/-.
- D) All that land described in the Certificate of Compliance recorded November 24, 2004 as Instrument No. 2004103175 OR, records of said County and State, containing 280.7 acres +/-.
- E) All that land described in the Quitclaim Deed recorded April 21, 2003 as Instrument No. 2003041292 OR, records of said County and State, containing 79.4 acres +/-.
- F) The Southeast one-quarter of the Northwest one-quarter, and the South one-half of the Northeast one-quarter of Section 19, T26S, R15, MDM, and the Southwest one-quarter of the Northwest one-quarter of Section 20, T26S, R15E, MDM, excepting from said Southwest one-quarter of the Northwest one-quarter of Section 20, the land described in the Grant Deed recorded June 21, 2013 as Instrument No. 2013036105 OR, records of said County and State, containing 147.7 acres +/-.
- G) All those parcels of land described in the following 5 Deeds:
 - a. Quitclaim Deed recorded March 26, 2009 as Instrument No. 2009014612 OR, records of said County and State
 - b. Quitclaim Deed recorded January 22, 2013 as Instrument No. 2013003920 OR, records of said County and State
 - c. Quitclaim Deed recorded May 19, 2009 as Instrument No. 2009026117 OR, records of said County and State
 - d. Grant Deed recorded November 13, 2007 as Instrument No. 2007074403 OR, records of said County and State
 - e. Grant Deed recorded October 29, 1999 as Instrument No. 1999077264 OR records of said County and State, containing 21.71 acres +/-.
- H) All those parcels of land described in the following 2 Grant Deeds:
 - a. Grant Deed recorded February 15, 2012 as Instrument No. 2012008371 OR, records of said County and State
 - b. Grant Deed recorded May 13, 2003 as Instrument No. 2003051143 OR, records of said County and State containing 36.6 acres +/-.
- I) All that land described as Parcel 2 in the Deed recorded May 16, 2008 as Instrument No. 2008025515 OR, records of said County and State containing 194.1 acres +/-.
- J) All that land described in the Trust Transfer Deed recorded April 12, 2006 as Instrument No. 2006025644 OR, records of said County and State containing 1.3 acre +/-.
- K) The West one-half of Section 32, T26S, R15E, MDM, containing 326.5 acres +/-.
- L) The Southwest one-quarter of the Northeast one-quarter and the Northwest one-quarter of the Southeast one-quarter of Section 5, T27S, R15E, MDM containing 81.6 acres +/-
- M) The South one-half of the South one-half of Section 4, all of Sections 9, 16, 17, 20, 21, 28, 29 and 33, the West one-half of the West one-half of Sections 22, 27, and 34, the East one-half and the East one-half of the West one-half of Section 19, the East one-half of Section 30, the Northeast one-quarter of Section 32, the North one-half of the Southeast one-quarter of Section 32, and the Southeast one-quarter of the Southeast one-quarter of Section 32, T27S, R15E, MDM containing 6,986.5 acres +/-.
- N) Parcel D of Parcel Map Co 79-138 filed in Parcel Map Book 32, Page 71, records of said County and State, containing 139.9 acres +/-
- O) Parcel F of Parcel Map Co 79-138 filed in Parcel Map Book 32, Page 71, records of said County and State, containing 64.9 acres +/-
- P) The East one-half of the West one-half of Section 35, T27S, R15E, MDM, containing 162.4 acres +/-

- Q) All that land described in the Deed recorded June 12, 1952 in Book 661, Page 175 OR, records of said County and State, containing 0.01 acre +/-

Excepting 13,304.7 acres more or less

TOGETHER WITH the following non-contiguous parcels of land:

- AA) All those parcels of land described in the following Deeds:
- 1) Grant Deed recorded December 18, 2013 as Instrument No. 2013068727 OR, records of said County and State.
 - 2) Grant Deed recorded March 20, 2014 as Instrument No. 2014010617 OR, records of said County and State.
 - 3) Grant Deed recorded December 5, 2007 as Instrument No. 2007078258 OR, records of said County and State, containing 1,362.2 acres +/-.
- BB) All those parcels of land described in the following 5 documents:
- 1) Correction Deed recorded March 7, 2007 as Instrument No. 2007015257 OR, records of said County and State.
 - 2) Grant Deed recorded September 30, 2013 as Instrument No, 2013055676 OR, records of said County and State.
 - 3) Certificate of compliance recorded December 7, 1981 in Book 2374, Page 28 OR, records of said County and State.
 - 4) Certificate of compliance recorded December 7, 1981 in Book 2374, Page 32 OR, records of said County and State.
 - 5) Certificate of compliance recorded December 7, 1981 in Book 2374, Page 36 OR, records of said County and State.
 - 6) Quitclaim Deed recorded May 7, 2002 as Instrument No. 2002038164 OR, records of said County and State.
 - 7) Also including the North one-half of the Southeast one-quarter of the Southwest one-quarter, and the Southwest one-quarter of the Southeast one-quarter of Section 31, T26S, R16E, MDM, containing 3,329.9 acres +/-.
- CC) All that land described in the Certificate of Compliance recorded November 14, 1994 as Instrument No. 1994066158 OR, records of said County and State, containing 159.8 acres +/-.
- DD) All that land described in the Grant Deed recorded July 21, 2016 as Instrument No. 2016035242 OR, records of said County and State, containing 10.0 acres +/-
- EE) All that land described in the Grant Deed recorded October 26, 2007 as Instrument No. 2007071166 OR, records of said County and State, containing 4.6 acres +/-.

Including 4,858.2 non-contiguous acres more or less

Entire District Area = 143,291.5 acres more or less

End of Description

The afore described lines and curves were derived from a composite of information, adjusted to overlay the GIS shapefile of the Public Land Survey System, available for download from the Natural Resource Conservation Service, United States Department of Agriculture (<https://gdg.sc.egov.usda.gov/GDGHome.aspx>), in an effort to create a closed polygon for LAFCO mapping and area calculation purposes. Lines and curves described within may vary from the values described in the various legal references. Controlling calls within the body of this description are paramount to the quantitative calls made within and hereby control the exterior boundary location of this Special District.

This Special District Boundary description was prepared by me in conformance with the requirements of the Professional Land Surveyors Act on May 22, 2017.

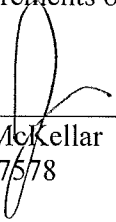

Jon McKellar
PLS 7578

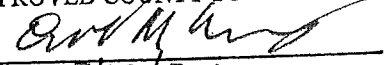

APPROVED COUNTY SURVEYOR

By: 
Date: 5/22/2017

San Luis Obispo County Dept. of Public Works

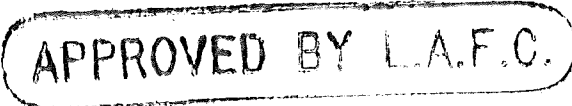

Exhibit B

Resolution 2016-08

IN THE LOCAL AGENCY FORMATION COMMISSION
COUNTY OF SAN LUIS OBISPO, STATE OF CALIFORNIA

October 20, 2016

Present: Chairman Frank Mecham, Commissioners Robert Enns, Roberta Fonzi, Tom Murray and Ed Waage, and Alternate Commissioners David Brooks and Ed Eby

Absent: Vice-Chairman Marshall Ochylski, Commissioners Bruce Gibson, and Alternate Commissioners Adam Hill and Jamie Irons

RESOLUTION NO. 2016-08

**RESOLUTION MAKING DETERMINATIONS AND APPROVING THE
FORMATION OF THE SHANDON-SAN JUAN WATER DISTRICT, SPHERE OF INFLUENCE,
AND ENVIRONMENTAL DETERMINATION**

The following resolution is now offered:

WHEREAS, a Petition of Application signed by 100 percent of the landowners within the proposed District boundary was filed with the Commission to initiate the formation of the Shandon-San Juan Water District; and

WHEREAS, application has been made to this Commission pursuant to the Cortese-Knox-Hertzberg Local Government Reorganization Act of 2000 (Government Code Sections 56000 et seq.) for consideration of a proposal for the formation of the Shandon-San Juan Water District as shown in Exhibit "A" attached hereto and made a part hereof; and

WHEREAS, the formation application of the Shandon-San Juan Water District, a Water District as defined in the California Water Code, Section 34000 et seq., has been filed with the Executive Officer of the Local Agency Formation Commission of San Luis Obispo County, California, Exhibit A by petition, and said application complied with all the requirements of law and the Commission; and

WHEREAS, the Executive Officer has given the notices required by law and forwarded copies of his report to officers, persons and public agencies prescribed by law; and

WHEREAS, the matter was set and noticed for public hearing at 9:00 a.m. on October 20, 2016 in the County of San Luis Obispo Board of Supervisors Chambers; and

WHEREAS, this Commission has considered the application materials, studies and other documentation at the October 20, 2016 public hearing which is incorporated by reference herein and the Benefit Assessment Plan found in Attachment C of the staff report; and

WHEREAS, on October 20, 2016 this Commission heard and received, all oral and written protests, objections and evidence, which were made, presented or filed, and all persons present were given the opportunity to hear and be heard in respect to any matter concerning this proposal; and

WHEREAS the Commission hereby finds that the formation of Water District will not have a significant effect on the environment, and is Categorically Exempt from the provisions of the California Environmental Quality Act (CEQA) under 15378(b)(4). Additionally, the SOI qualifies for a general rule exemption from environmental review based upon CEQA Regulation Section 15061(b)(3) and Section 15262; and

WHEREAS, the Commission duly considered the proposal and finds that the formation should be approved with the following conditions:

1. The name of the Water District shall be the Shandon-San Juan Water District.
2. That the Board of Directors of the Shandon-San Juan Water District be composed of five members elected as provided for in the California Water District Law, Water Code Section 34000 et. seq. The initial Board of Directors will be elected pursuant to the Water Code sections 34700; and
3. That pursuant to the applicable Water Code Sections the Shandon-San Juan Water District is authorized to exercise all powers and authorities subject to the following restrictions:
 - a. The Water District's powers to export, transfer, or move water underlying the Water District outside of the Paso Robles Groundwater Basin shall not be active and are subject to condition number five of this approval. For purposes of this Condition and Condition number five, "groundwater" shall have the meaning set forth in Water Code Section 10721(g).
 - b. The Water District's powers under Part 5 Powers and Purpose; Chapter 2; Powers; Article 5; Sewers: [35500 - 35509] of the California Water Code shall be deemed inactive or latent. The Water District could request LAFCO activate these powers in the future.
4. That formation of the Shandon-San Juan Water District shall be contingent upon a successful vote on the formation pursuant to Water Code Section 34500, and the Water

District completing a successful benefit assessment to fund the activities of the Water District. If the Proposition 218 proceeding is not successfully conducted within one year of the certificate of completion, the Water District shall be subject to dissolution. LAFCO may extend this deadline upon request by the District.

5. The Water District shall be prohibited from exporting, transferring, or moving water underlying the Water District (including groundwater pumped into an above ground storage facility) to areas outside of the Paso Robles Groundwater Basin.
6. That specific projects proposed by the Shandon-San Juan Water District shall be analyzed and evaluated in accordance with applicable laws prior to construction.
7. That a revised legal description and boundary map(s) be submitted to reflect the service area and sphere of influence boundaries of the Water District as adopted by the Commission.
8. That the effective date of the Shandon-San Juan Water District will be determined by the certification of the election results by the Board of Supervisors and the filing of the certificate of completion by the LAFCO Executive Officer with the County Clerk-Recorder's office.
9. That the Water District set the appropriations limit as soon as feasibly possible consistent with Government Code Section 57000.
10. The Sphere of Influence of the Shandon-San Juan Water District shall be co-terminus to the Service Area boundary. Future amendments and/or updates of the SOI shall only include properties that have submitted written landowner consent for inclusion in the SOI.
11. The District, if formed, shall provide documentation that it has been identified as a Groundwater Sustainability Agency (GSA), or a GSA partner, pursuant to the Sustainable Groundwater Management Act. If the District does not become a GSA, or is not part of a GSA within one year of the Certificate of Completion being filed, the District shall either submit a resolution stating which activities it shall be undertaking that justify its continuation to the satisfaction of LAFCO, or it shall submit a resolution of application to LAFCO requesting dissolution, LAFCO may extend this deadline upon request by the Water District.

NOW, THEREFORE, the San Luis Obispo County Local Agency Formation Commission determines the following:

1. The territory comprises approximately 144,000 acres and is found to be inhabited (having more than twelve registered voters) as defined in §56046 of the Government Code, and is a landowner-voter District subject to Water Code Section 34000, et seq.
2. The formation of the District is assigned the following distinctive short-form designation: Shandon-San Juan Water District.

3. Based on the evidence, analysis, and conclusions set forth in this resolution and the Executive Officer's report and attachments, the Commission finds that the formation of this District serves to further the purposes of the Cortese-Knox-Hertzberg Local Government Reorganization Act of 2000 including, but not limited to, the following: efficiently providing government services and facilitating the orderly formation and development of local agencies based upon local conditions and circumstances.
4. The Commission determines, based upon the services currently provided to the affected territory, that the Shandon-San Juan Water District can feasibly provide the needed services in a more efficient and accountable manner than other agencies in the area.
5. The Commission adopts the determinations regarding consistency with LAFCO law and Commission Policies contained in the staff report and attachments for this proposal and incorporates them by reference herein.
6. The affected territory within which the special election shall be held includes the entire area within the boundaries of the proposed Water District, as described by Exhibit A attached hereto.

NOW, THEREFORE, BE IT RESOLVED AND ORDERED by the Local Agency Formation Commission of the County of San Luis Obispo, State of California, as follows:

1. That the recitals set forth hereinabove are true, correct, and valid.
2. That the Categorical Exemption prepared for this project is hereby approved as complete and adequate and as having been prepared in accordance with the provisions of the California Environmental Quality Act.
3. The Executive Officer, on behalf of the Commission and in compliance with this resolution and State law, hereby requests that the San Luis Obispo County Board of Supervisors direct the County Elections Official to conduct the necessary election, setting the matter for consideration of the voters of the affected territory on a date consistent with election law and the Cortese-Knox-Hertzberg Act. The Executive Officer is directed to coordinate with the County Clerk to formulate the election questions consistent with the Commission's determinations set forth herein.
4. That the Executive Officer of this Commission is authorized and directed to mail copies of this resolution in the manner provided by law.
5. That Formation of the Shandon-San Juan Water District is hereby conditionally approved.
6. Pursuant to §57144 and §56898 of the Government Code, the Executive Officer will prepare for the Commission's review an Impartial Analysis of the proposed District formation; after the Commission has approved or modified the Impartial Analysis, it shall

direct the Executive Officer to submit it to the elections official no later than the last day for submission of ballot arguments.

7. The regular County assessment roll will be used.

Upon a motion by Commissioner Waage, seconded by Commissioner Murray to adopt the Resolution and make the determinations approving the formation of the Shandon-San Juan Water District and Sphere of Influence and Environmental Determination as proposed with the Revise Conditions of Approval with inclusion of the additional inclusion requests received.

AYES: Commissioners Waage, Murray, Eby, Enns, and Chairman Mecham

NAYS: Fonzi

ABSTAIN: None

The foregoing resolution is hereby adopted.

Frank Mecham, Chair Date
Local Agency Formation Commission

ATTEST:

 11/21/16

David Church Date
LAFCO Executive Officer

APPROVED AS TO FORM AND LEGAL EFFECT:

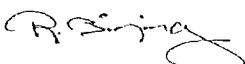

Raymond A. Biering 10/26/16
LAFCO Legal Counsel Date

Tommy Gong
San Luis Obispo
County Clerk-Recorder
Main Office: (805) 781-5080
Atascadero: (805) 461-6041
www.slovote.com

Receipt: 17-12215

ProductName	Extended
0176 NOTICE OF COMPLETION	\$0.00
Document #	2017022283
Document Info:	PUBLIC
# Pages	37
<hr/>	
Total	\$0.00
Change (Cash)	\$0.00

PLEASE KEEP FOR REFERENCE

5/22/17 3:02 PM dchavez
San Luis Obispo